

# 1. Exploded View & Part List

## Exploded View

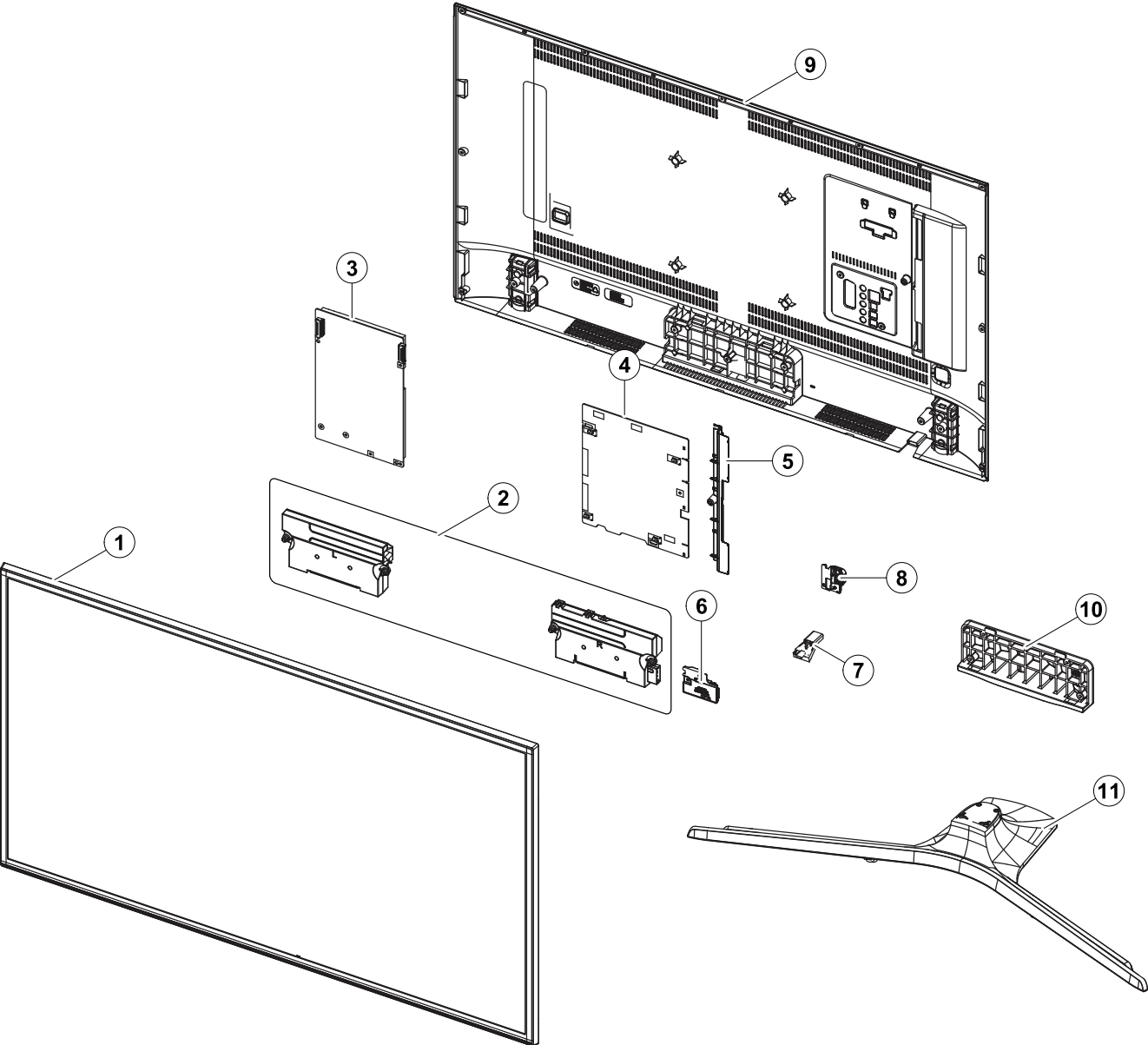

## Parts List

No.	Lvl.	Loc.	Material Code	Description & Specification	SNA	Qty.
1	1		BN95-03651A	PRODUCT LCD DP; DP,BN95-02697A,SEH ONLY	SA	1
2	2		BN96-35007A	ASSY SPEAKER P-FRONT; TV-SPK,JU6400,6ohm,	SA	1
3	2	P001A	BN44-00806A	DC VSS-PD BOARD; L40S6_FDY,AC/DC,139W,100	SA	1
4	2	M0014	BN94-12085F	ASSY PCB MAIN; UMU6100N,40	SA	1
5	3		BN63-16652A	COVER-TERMINAL SIDE; 55MU6400,HIPS,HB,BK0	SA	1
6	2		BN59-01264A	NETWORK-WLAN CLIENT; WCM730Q,78.3x29.3x7.	SA	1
7	2		BN96-39955A	ASSY BOARD P-IR FUNCTION; KU6000,IR ASSY_	SA	1
8	2	JOG	BN96-35345B	ASSY BOARD P-FUNCTION JOG; JU7500,CT15SE8	SA	1
9	2	R001A	BN96-43324C	ASSY COVER P-REAR; 43MU6100,PC+ABS,V-1,BK	SA	1
10	2	SG03	BN61-11465A	GUIDE-STAND; 40J5100,PC+GF20%,V-2,BK0007,	SA	1
11	2	SB04A	BN96-35224A	ASSY STAND P-BOTTOM; J5500 40",PC+ABS+GF2	SA	1

## 2. Electrical Parts List

Level	Loc.	Part Code	Description & Specification	Qty.	SA/SNA
			<b>UE43MU6105KXXC (BA02)</b>		
1	S001A	BN90-06496D	ASSY STAND;J5000	1	SNA
.2	SG03	BN61-11465A	GUIDE-STAND;40J5100,PC+GF20%,V-2,BK0007,	1	SA
..3		0103-007285	RESIN PC;HF3200H,K21294,BK0007,V-2,GF20%	280	SNA
.2	SB04A	BN96-35224A	ASSY STAND P-BOTTOM;J5500 40",PC+ABS+GF2	1	SA
..3	SCREW	6003-001001	SCREW-TAPTYPE;FH,+,-,B,M3,L8,ZPC(BLK),SW	2	SA
..3		6902-002486	BAG PE;HDPE/PE FOAM,T0.015/T0.5,W100,L35	2	SNA
..3		6902-002487	BAG PE;HDPE/PE FOAM,T0.015/T0.5,W250,L35	1	SNA
..3		BN61-07463B	TAPE-DOUBLE FACE;ACRYL,T0.25,W7,CLEAR	0	SNA
..3	HOLDER	BN01-09494D	HOLDER-BOLT;KU6500,SWRCH18A,BLACK,B TYPE	2	SA
..3		BN61-11430A	BRACKET-STAND BODY;HGI,T1.6,NATURAL,12.7	1	SNA
..3		BN63-13258A	COVER-STAND TOP;40J5100,PC+ABS+GF20%,V-1	1	SNA
...4		0103-009946	RESIN PC ABS;HM-1200,BLACK,BK0007,V-1,GF	300	SNA
..3	RF01	BN67-00398L	FOOT-RUBBER;UH6K,Si,GRAY,W8,L15.5,T2	1	SNA
..3	RF01	BN67-00538A	FOOT-RUBBER;LED_J4000,Si,GRAY,W8,L15.5,T	4	SNA
..3		BN95-02140A	ASSY COVER STAND SMT;J5500 STAND,40,Silv	1	SNA
...4		0204-007674	COATING;UVICHEM CVM93000(VOC) MATT(5),CL	1	SNA
...4		BN01-00160A	TARGET-CHROMIUM CY;Cr,99.95%,1800x132x80	0	SNA
...4		BN01-00336A	TARGET-ALUMINIUM CY;Al,99.9%,1724mm,132d	0	SNA
...4		BN63-13262A	COVER-STAND DECORATION;40J5100,PC+ABS,V-	1	SNA
....5		0103-005041	RESIN PC ABS;FR3200TV,901408,BK0008,1.2m	62	SNA
1	R001A	BN90-09058C	ASSY COVER REAR;UMU6100N,43	1	SNA
.2	SCREW	6001-002755	SCREW-MACHINE;BH,+,-,M3,L6,ZPC(BLK),SWRCH1	15	SA
.2	R001A	BN96-43324C	ASSY COVER P-REAR;43MU6100,PC+ABS,V-1,BK	1	SA
..3	R001	BN63-14785Q	COVER-REAR;43KU6000,PC+ABS,V-1,BK0008,EO	1	SNA
...4		0103-010376	RESIN PC ABS;FR3012 / 901510,BLACK,BK000	1775	SNA
..3		BN64-03903A	INLAY-TERMINAL SIDE;55MU6100,PET,T0.125,	1	SNA
..3		BN68-03518R	LABEL-STICKER CI SLOT;55KU6000,PET,T0.12	1	SNA
1		BN90-09071B	ASSY W/I;UMU6100N	1	SNA
.2		BN81-08159Z	A/S PART SET-ELEC W/I;LED TV ELEC spec-C	1	SNA
.2		BN81-15300B	A/S PART SET-MECH W/I;UMU6100N,U43MN*	1	SNA
1		BN91-18918A	ASSY SHIELD;UMU6100N,43	1	SNA
.2	SCREW	6001-003016	SCREW-MACHINE;PWH,+,-,M3,L5.0,ZPC(WHT),SWR	5	SA
.2		BN02-00102B	TAPE-SINGLE FACE;FILAMENT,#8917,T0.15,W2	0	SNA
.2	12P	BN39-02025A	LEAD CONNECTOR-POWER;UN40JU6400AFXZA,UL2	1	SA
.2		BN39-02030E	LEAD CONNECTOR-BLU;BLU,UL21016,16P,80mm,	1	SA
.2	EC13	BN39-02219D	LEAD CONNECTOR;40KU6300, 43KU6300, 50KU6	1	SA
.2		BN39-02220A	LEAD CONNECTOR-SUB ASSY;40KU6300,UL21016	1	SA

Exploded Views and Parts List

Level	Loc.	Part Code	Description & Specification	Qty.	SA/SNA
.2	P001A	BN44-00806A	DC VSS-PD BOARD;L40S6_FDY,AC/DC,139W,100	1	SA
.2		BN59-01264A	NETWORK-WLAN CLIENT;WCM730Q,78.3x29.3x7.	1	SA
.2		BN61-09637A	HOLDER-WIFI;KU6000,ABS,BK0007,HB	1	SA
.2		BN96-35007A	ASSY SPEAKER P-FRONT;TV-SPK,,JU6400,6ohm,	1	SA
.2	JOG	BN96-35345B	ASSY BOARD P-FUNCTION JOG;JU7500,CT15SE8	1	SA
.2		BN96-39955A	ASSY BOARD P-IR FUNCTION;KU6000,IR ASSY_	1	SA
1	M0017	BN91-18956F	ASSY CHASSIS;UMU6100N,40	1	SNA
.2	M0014	BN94-12085F	ASSY PCB MAIN;UMU6100N,40	1	SA
...3		0202-001608	SOLDER-WIRE FLUX;LFC7-107,D0.8,99.3Sn/0.	0	SNA
...3		BN62-00834A	HEAT SINK-PS;KANT_M heatsink,A1050,T1.5,	1	SNA
...3		BN63-16652A	COVER-TERMINAL SIDE;55MU6400,HIPS,HB,BK0	1	SA
...3		BN97-12859A	ASSY DRM;Kant_M,DVB,NagSam, MAC, HDCP, C	1	SNA
...4		BN46-00109H	KEY CODE-CERTIFICATION;MAC,TV/AV,General	1	SNA
...4		BN46-00110P	KEY CODE-CERTIFICATION;MIRACAST(HDCP2.2)	1	SNA
...4		BN46-00601A	KEY CODE-CERTIFICATION;KANT-M,CI PLUS,Sa	1	SNA
...4		BN46-00604A	KEY CODE-CERTIFICATION;KANT-M,Nagra CSC	1	SNA
...3		BN97-12957B	ASSY MICOM;TCON DATA_43BOE_F,MU6100	1	SNA
...4		BN46-00663A	S/W MICOM;M43B6U0F,43B6AU0VK,43BOE_F	1	SNA
...3		BN97-12961T	ASSY SMD;UMU6100N,55	1	SNA
...4		0202-001976	SOLDER-CREAM;LST-309M-K21,D20~38um,96.5S	5	SNA
...4	DS01A	0401-001056	DIODE-SWITCHING;MMBD4148SE,100V,200mA,SO	1	SA
...4		0403-001783	DIODE-ZENER;BZB84-C6V2,5.8~6.6V,300mW,SO	3	SNA
...4		0403-001831	DIODE-ZENER;KDZ12B,12~13.5V,1000mW,SOD-1	1	SA
...4		0403-002014	DIODE-ZENER;KDZ16B,16.2~18.3V,1000mW,SOD	1	SNA
...4		0404-001307	DIODE-SCHOTTKY;SSC54,40V,5000mA,DO-214AB	1	SA
...4		0404-001404	DIODE-SCHOTTKY;BAT721C,40V,200mA,SOT-23,	2	SA
...4		0404-001640	DIODE-SCHOTTKY;SS1060HEWS,60V,1000mA,SOD	2	SA
...4		0404-001881	DIODE-SCHOTTKY;SS3040-HE,40V,3000mA,SOD-	1	SA
...4		0404-001953	DIODE-SCHOTTKY;MBRA340F-HAF,40V,3000mA,S	3	SA
...4		0406-001200	DIODE-TVS;RClamp0504F,6V,1MAV,TP	5	SA
...4		0406-001635	DIODE-TVS;SMF5.0A,6.4V,6.7V,7V,200MAV,20	1	SA
...4		0406-001718	DIODE-TVS;SMF36A,40V,44.2V,3.8MAV,1.25VP	1	SA
...4		0406-001778	DIODE-TVS;PUSB3FR4,6V,9V,0.2MAV,0.7VPA,0	1	SA
...4		0406-001786	DIODE-TVS;PJEC5V0V6TM,5V,7V,8V,0.1MAV,9V	1	SA
...4		0501-000445	TR-SMALL SIGNAL;KTC3875S-Y,NPN,150mW,SOT	4	SC
...4		0504-000126	TR-DIGITAL;KSR1101,NPN,200mW,4.7K/4.7K,S	1	SA
...4		0505-001844	FET-SILICON;SI4435DDY-T1-GE3,P,30V,-11.4	1	SA
...4		0505-002560	FET-SILICON;AO6415,P,20V,-3.3A,0.15ohm,1	1	SA
...4		0505-002598	FET-SILICON;AP2317GN,P,20V,-4.2A,0.052oh	1	SA
...4		0505-002660	FET-SILICON;Si2308BDS,N,60V,2.3A,0.156oh	1	SA

Level	Loc.	Part Code	Description & Specification	Qty.	SA/SNA
...4		0505-002893	FET-SILICON;AO4801AS,P,30V,-5A,2W,SOIC-8	1	SA
...4		0505-003205	FET-SILICON;DMG4435SSS-13,P,30V,-7.3A,1.	1	SA
...4		0505-003391	FET-SILICON;AOD2922,N,100V,8A,140Mohm,18	1	SA
...4		0505-003397	FET-SILICON;2N7002K,N,60V,0.38A,1.19ohm,	1	SA
...4		0505-003507	FET-SILICON;AO3424,N,30V,3.8A,1.4W,SOT-2	4	SA
...4		0801-003603	IC-CMOS LOGIC;MC74LCX244MN2TWG,Octal buf	1	SA
...4		1001-001998	IC-ANALOG MULTIPLEX;NX3DV221GM,USB switc	1	SA
...4		1003-002878	IC-LEVEL DRIVER;VLS1RO,QFN,46P,4.5x6.5x1	1	SA
...4		1103-001564	IC-EEPROM;S-24C512CI-J800,512Kbit,64Kx8,	1	SA
...4		1105-002704	IC-DDR4 SDRAM;K4F8E304HB-MGCH,LPDDR4-SDR	2	SA
...4		1201-000166	IC-OP AMP;LM358,SOP,ST,8P,150MIL,DUAL,10	1	SA
...4		1201-004117	IC-AUDIO AMP;TAS5749M,QFP,48P,7x7x1mm,DU	1	SA
...4		1203-004363	IC-VOL. DETECTOR;SOT-23,3Z30,2.9x1.6mm,P	1	SA
...4		1203-008082	IC-DC/DC CONVERTER;TPS54627DDAR,SOP 8P,8	1	SA
...4		1203-008104	IC-POSI.FIXED REG.;S-13A1D18-E800,HSOP,8	1	SNA
...4		1203-008105	IC-POSI.FIXED REG.;S-13A1D33-E800,HSOP,8	1	SNA
...4		1203-008392	IC-VOL. DETECTOR;S-6414AAB-L800X,TSOT-23	1	SA
...4		1203-008777	IC-DC/DC CONVERTER;TPS563201,SOT-23,6,1.	4	SA
...4		1203-008880	IC-DC/DC CONVERTER;VPM1RO,QFN,68P,8x8x1m	1	SA
...4		1203-008917	IC-DC/DC CONVERTER;G5334CQT1U,QFN4,23P,4	1	SA
...4		1203-008919	IC-DC/DC CONVERTER;SYD104ADC,TSOT23,6P,	1	SA
...4		1203-008921	IC-DC/DC CONVERTER;SYU236ARAC,QFN,20P,3x	1	SA
...4		1203-008933	IC-POSI.ADJUST REG.;G942F11U,SOP,8P,4.9x	1	SA
...4		1204-003714	IC-DECODER;SDP1601,FCPBGA,1147P,31x31x2.	1	SA
...4		1205-005519	IC-SWITCH;ET20163,SOT23-5,5P,2.95x3.02mm	3	SA
...4		1205-005537	IC-REPEATER;TCA9517,VSSOP,8P,3.00x3.00mm	3	SA
...4		1205-005749	IC-SWITCH;G2897KD1U,TDFN2X3-14,14P,2x3mm	2	SA
...4		1404-001731	THERMISTOR-NTC;33Kohm,4050K,1mW/C,TP,1.6	1	SNA
...4		1405-001232	VARISTOR;6.4V,5.6VDC,30A,1608,TP,19V,200	7	SNA
...4		1405-001271	VARISTOR;35V,20VDC,5A,1005,TP,100V,10pF	25	SA
...4		1405-001381	VARISTOR;11V,8VDC,30A,1608,TP,25V,500pF	3	SA
...4		1405-001382	VARISTOR;24.5V,16VDC,120A,2012,TP,42V,40	1	SA
...4		2007-000039	R-CHIP;0ohm,1%,1/10W,TP,1608	4	SA
...4		2007-000052	R-CHIP;10Kohm,1%,1/10W,TP,1608	1	SA
...4		2007-000066	R-CHIP;20Kohm,1%,1/10W,TP,1608	1	SNA
...4		2007-000070	R-CHIP;0ohm,5%,1/10W,TP,1608	22	SA
...4		2007-000137	R-CHIP;2Kohm,5%,1/16W,TP,1005	4	SNA
...4		2007-000138	R-CHIP;100ohm,5%,1/16W,TP,1005	1	SA
...4		2007-000143	R-CHIP;4.7Kohm,5%,1/16W,TP,1005	10	SNA
...4		2007-000146	R-CHIP;6.8Kohm,5%,1/16W,TP,1005	1	SNA

Exploded Views and Parts List

Level	Loc.	Part Code	Description & Specification	Qty.	SA/SNA
...4		2007-000148	R-CHIP;10Kohm,5%,1/16W,TP,1005	3	SA
...4		2007-000170	R-CHIP;1Mohm,5%,1/16W,TP,1005	1	SNA
...4		2007-000171	R-CHIP;0ohm,5%,1/16W,TP,1005	18	SNA
...4		2007-000683	R-CHIP;3.3Kohm,1%,1/10W,TP,1608	1	SA
...4		2007-000772	R-CHIP;33Kohm,1%,1/10W,TP,1608	1	SA
...4		2007-000779	R-CHIP;33ohm,1%,1/10W,TP,1608	2	SA
...4		2007-000932	R-CHIP;470ohm,5%,1/16W,TP,1005	3	SNA
...4		2007-000979	R-CHIP;5.6Kohm,1%,1/10W,TP,1608	1	SA
...4		2007-001125	R-CHIP;68Kohm,1%,1/10W,TP,1608	2	SA
...4		2007-001288	R-CHIP;18ohm,5%,1/16W,TP,1005	4	SA
...4		2007-001292	R-CHIP;33ohm,5%,1/16W,TP,1005	27	SNA
...4		2007-001298	R-CHIP;51ohm,5%,1/16W,TP,1005	13	SNA
...4		2007-002899	R-CHIP;10ohm,1%,1/10W,TP,1608	20	SA
...4		2007-002906	R-CHIP;200Kohm,1%,1/10W,TP,1608	1	SA
...4		2007-007107	R-CHIP;100Kohm,1%,1/16W,TP,1005	12	SNA
...4		2007-007131	R-CHIP;13Kohm,1%,1/16W,TP,1005	6	SA
...4		2007-007132	R-CHIP;15Kohm,1%,1/16W,TP,1005	3	SA
...4		2007-007136	R-CHIP;4.7Kohm,1%,1/16W,TP,1005	64	SNA
...4		2007-007137	R-CHIP;1.2Kohm,1%,1/16W,TP,1005	2	SA
...4		2007-007138	R-CHIP;27Kohm,1%,1/16W,TP,1005	1	SA
...4		2007-007139	R-CHIP;47Kohm,1%,1/16W,TP,1005,T0.35	9	SA
...4		2007-007142	R-CHIP;10Kohm,1%,1/16W,TP,1005	34	SNA
...4		2007-007305	R-CHIP;120ohm,1%,1/16W,TP,1005	1	SNA
...4		2007-007306	R-CHIP;100ohm,1%,1/16W,TP,1005	14	SNA
...4		2007-007308	R-CHIP;33Kohm,1%,1/16W,TP,1005	3	SA
...4		2007-007309	R-CHIP;12Kohm,1%,1/16W,TP,1005,T0.35	1	SA
...4		2007-007310	R-CHIP;8.2Kohm,1%,1/16W,TP,1005	5	SA
...4		2007-007311	R-CHIP;22Kohm,1%,1/16W,TP,1005	1	SA
...4		2007-007312	R-CHIP;20Kohm,1%,1/16W,TP,1005	16	SA
...4		2007-007313	R-CHIP;6.8Kohm,1%,1/16W,TP,1005	6	SA
...4		2007-007315	R-CHIP;3.9Kohm,1%,1/16W,TP,1005	1	SNA
...4		2007-007317	R-CHIP;2.2Kohm,1%,1/16W,TP,1005	2	SA
...4		2007-007318	R-CHIP;1Kohm,1%,1/16W,TP,1005	12	SNA
...4		2007-007334	R-CHIP;200Kohm,1%,1/16W,TP,1005	4	SNA
...4		2007-007488	R-CHIP;75Kohm,1%,1/16W,TP,1005	1	SA
...4		2007-007517	R-CHIP;240ohm,1%,1/16W,TP,1005	5	SNA
...4		2007-007520	R-CHIP;20ohm,1%,1/10W,TP,1608	1	SA
...4		2007-007528	R-CHIP;1.5Kohm,1%,1/16W,TP,1005	5	SA
...4		2007-007588	R-CHIP;1.8Kohm,1%,1/16W,TP,1005	1	SA
...4		2007-007697	R-CHIP;2.4Kohm,1%,1/16W,TP,1005	1	SNA

Level	Loc.	Part Code	Description & Specification	Qty.	SA/SNA
...4		2007-007736	R-CHIP;510Kohm,1%,1/10W,TP,1608	1	SA
...4		2007-007766	R-CHIP;2Kohm,1%,1/16W,TP,1005	21	SNA
...4		2007-007767	R-CHIP;200ohm,1%,1/16W,TP,1005	4	SA
...4		2007-007798	R-CHIP;10ohm,1%,1/16W,TP,1005	6	SA
...4		2007-008015	R-CHIP;75ohm,1%,1/16W,TP,1005	7	SA
...4		2007-008294	R-CHIP;33ohm,1%,1/16W,TP,1005	4	SA
...4		2007-008298	R-CHIP;49.9ohm,1%,1/16W,TP,1005	5	SA
...4		2007-008596	R-CHIP;0.1ohm,1%,1/4W,TP,3216	3	SC
...4		2007-009322	R-CHIP;1.3Kohm,1%,1/16W,TP,1005	5	SA
...4		2007-009777	R-CHIP;4.99Kohm,1%,1/16W,TP,1005	1	SA
...4		2011-001261	R-NETWORK;33ohm,5%,1/16W,L,CHIP,8P,TP,2.	6	SA
...4		2011-001264	R-NETWORK;10ohm,5%,1/16W,L,CHIP,8P,TP,2.	17	SNA
...4		2011-001344	R-NETWORK;100ohm,5%,1/16W,L,CHIP,8P,TP,2	9	SA
...4		2011-001448	R-NETWORK;10ohm,5%,1/16W,L,4P,TP,1.0x1.0	1	SA
...4		2011-001506	R-NETWORK;10Kohm,5%,1/16W,L,CHIP,4P,TP,1	1	SNA
...4		2011-001527	R-NETWORK;4.7Kohm,5%,1/16W,L,CHIP,4P,TP,	4	SNA
...4		2011-001586	R-NETWORK;1Kohm,5%,1/16W,L,CHIP,4P,TP,1.	2	SNA
...4		2011-001587	R-NETWORK;100ohm,5%,1/16W,L,CHIP,4P,TP,1	3	SNA
...4	AD480	2203-000233	C-CER,CHIP;0.1nF,5%,50V,C0G,TP,1005	4	SA
...4	AD480	2203-000278	C-CER,CHIP;0.01nF,0.5pF,50V,C0G,TP,1005	6	SA
...4	AD480	2203-000359	C-CER,CHIP;0.15nF,5%,50V,C0G,TP,1005,T0.	3	SA
...4	AD480	2203-000425	C-CER,CHIP;0.018nF,5%,50V,C0G,TP,1005	2	SA
...4	AD480	2203-000438	C-CER,CHIP;1nF,10%,50V,X7R,TP,1005	8	SA
...4	AD480	2203-000489	C-CER,CHIP;2.2nF,10%,50V,X7R,TP,1005	2	SA
...4	AD480	2203-000585	C-CER,CHIP;0.22nF,10%,50V,X7R,TP,1005	4	SA
...4	AD480	2203-000812	C-CER,CHIP;0.033nF,5%,50V,C0G,TP,1005	3	SA
...4	AD480	2203-000940	C-CER,CHIP;0.47nF,10%,50V,X7R,TP,1005	4	SA
...4	AD480	2203-001072	C-CER,CHIP;0.056nF,5%,50V,C0G,TP,1005	1	SA
...4	AD480	2203-001851	C-CER,CHIP;0.016nF,5%,50V,C0G,TP,1608	1	SNA
...4	AD480	2203-002285	C-CER,CHIP;10nF,10%,50V,X7R,TP,1005	8	SNA
...4	AD480	2203-002525	C-CER,CHIP;0.56nF,10%,50V,X7R,TP,1005	1	SNA
...4	AD480	2203-002720	C-CER,CHIP;10nF,10%,25V,X7R,TP,1005,T0.5	1	SNA
...4	AD480	2203-005057	C-CER,CHIP;0.0082nF,0.25pF,50V,C0G,TP,10	2	SA
...4	AD480	2203-005083	C-CER,CHIP;220nF,10%,50V,X7R,TP,1608,T0.	6	SA
...4	AD480	2203-005249	C-CER,CHIP;100nF,10%,50V,X7R,TP,1608	5	SNA
...4	AD480	2203-005642	C-CER,CHIP;0.22nF,5%,50V,C0G,TP,1005	2	SNA
...4	AD480	2203-005968	C-CER,CHIP;4.7nF,10%,50V,X7R,TP,1005,T0.	2	SNA
...4	AD480	2203-005993	C-CER,CHIP;68nF,10%,16V,X7R,1005	1	SA
...4	AD480	2203-006048	C-CER,CHIP;100nF,10%,10V,X7R,TP,1005	1	SA
...4	AD480	2203-006126	C-CER,CHIP;47nF,10%,16V,X7R,TP,1005	3	SNA

Exploded Views and Parts List

Level	Loc.	Part Code	Description & Specification	Qty.	SA/SNA
...4	AD480	2203-006158	C-CER,CHIP;100nF,10%,16V,X7R,TP,1005,T0.	219	SNA
...4	AD480	2203-006324	C-CER,CHIP;2200nF,10%,10V,X5R,TP,1608	15	SA
...4	AD480	2203-006348	C-CER,CHIP;1000nF,10%,25V,X5R,TP,1608,T0	1	SA
...4	AD480	2203-006562	C-CER,CHIP;1000nF,10%,10V,X5R,TP,1005	19	SNA
...4	AD480	2203-006636	C-CER,CHIP;220nF,10%,25V,X7R,TP,1608	1	SA
...4	AD480	2203-006698	C-CER,CHIP;1000nF,10%,25V,X7R,TP,1608,T0	11	SA
...4	AD480	2203-006824	C-CER,CHIP;4700nF,10%,10V,X5R,TP,1608	4	SNA
...4	AD480	2203-006838	C-CER,CHIP;2200nF,10%,6.3V,X5R,TP,1005	3	SA
...4	AD480	2203-006841	C-CER,CHIP;1000nF,10%,16V,X5R,TP,1005	1	SNA
...4	AD480	2203-006844	C-CER,CHIP;470nF,10%,10V,X5R,TP,1005	2	SA
...4	AD480	2203-006890	C-CER,CHIP;10000nF,20%,6.3V,X5R,TP,1608	66	SA
...4	AD480	2203-007176	C-CER,CHIP;10000nF,10%,16V,X5R,TP,2012,T	11	SNA
...4	AD480	2203-007240	C-CER,CHIP;22000nF,20%,6.3V,X5R,TP,1608,	63	SA
...4	AD480	2203-007269	C-CER,CHIP;22000nF,20%,10V,X5R,TP,2012(2	19	SA
...4	AD480	2203-007270	C-CER,CHIP;10000nF,10%,10V,X5R,TP,1608,T	10	SNA
...4	AD480	2203-007306	C-CER,CHIP;10000nF,10%,25V,X5R,TP,2012,1	33	SNA
...4	AD480	2203-007423	C-CER,CHIP;10000nF,10%,35V,X7R,TP,3216	4	SA
...4	AD480	2203-007486	C-CER,CHIP;1000nF,10%,50V,X5R,TP,1608	2	SNA
...4	AD480	2203-007544	C-CER,CHIP;100nF,10%,50V,X7R,TP,1005,T0.	14	SA
...4	AD480	2203-008096	C-CER,CHIP;2200nF,10%,50V,X5R,TP,2012,1.	1	SA
...4	AD480	2203-008315	C-CER,CHIP;22000nF,20%,25V,X5R,TP,2012,T	6	SA
...4	AD480	2203-008412	C-CER,CHIP;4700nF,10%,50V,X5R,TP,2012,1.	2	SNA
...4		2402-001268	C-AL,SMD;100uF,20%,25V,WT,TP,8x6.3mm	1	SA
...4		2409-001240	C-ORGANIC,SMD;33uF,20%,25V,LR,TP,7343(1.	1	SA
...4		2703-000213	INDUCTOR-SMD;470nH,10%,1.35Ohm,35mA,15,M	1	SA
...4		2703-002269	INDUCTOR-SMD;56nH,5%,1005,T0.5,1.40hm,15	3	SA
...4		2703-003747	INDUCTOR-SMD;22uH,20%,6060,0.135ohm,1300	2	SA
...4		2703-003754	INDUCTOR-SMD;1uH,20%,1608,T0.8,0.240hm,9	1	SNA
...4		2703-003862	INDUCTOR-SMD;10uH,20%,6060,0.065ohm,1900	4	SA
...4		2703-003937	INDUCTOR-SMD;1uH,20%,70647,T3,0.0080hm,1	1	SA
...4		2703-004630	INDUCTOR-SMD;2.2uH,20%,7070,T5,0.00250hm	2	SNA
...4		2703-004724	INDUCTOR-SMD;8.2uH,20%,5050,T4,0.0720hm,	4	SA
...4		2703-005191	INDUCTOR-SMD;1.5uH,20%,6060,T4.5,0.020hm	5	SA
...4		2703-005376	INDUCTOR-SMD;10uH,20%,10.7x10mm,T3.8,0.0	1	SA
...4		2801-004021	CRYSTAL-SMD;24.576MHz,20ppm,28-AAN,12pF,	2	SA
...4		3301-002039	BEAD-SMD;26ohm,1608,TP	43	SA
...4		3601-001374	FUSE-SURFACE MOUNT;32V,5A,FAST-ACTING,PL	3	SA
...4		3601-001376	FUSE-SURFACE MOUNT;32V,3A,FAST-ACTING,Hi	1	SNA
...4		3701-001967	CONNECTOR-HDMI;19P,A,FEMALE,AU,0.5mm,BLK	3	SA
...4		3707-001104	CONNECTOR-OPTICAL;ANGLE,SPDIF	1	SA



Level	Loc.	Part Code	Description & Specification	Qty.	SA/SNA
...4		3708-003241	CONNECTOR-FPC/FFC/PIC;96P,0.5mm,SMD-A,AU	2	SNA
...4		3710-003908	CONNECTOR-SOCKET;64P,2R,0.5mm,SMD-S,AU,B	1	SA
...4	EH01	3711-007803	HEADER-BOARD TO CABLE;BOX,12P,1R,1.25mm,	1	SA
...4	EH01	3711-008098	HEADER-BOARD TO CABLE;BOX,20P,1R,1.25mm,	1	SNA
...4	EH01	3711-008131	HEADER-BOARD TO CABLE;BOX,4P,1R,2.5mm,AN	1	SA
...4	EH01	3711-008859	HEADER-BOARD TO CABLE;BOX,12P,2R,2mm,ANG	1	SA
...4		3711-009090	CONNECTOR-HEADER;BOX,16P,1R,1.25mm,SMD-A	1	SA
...4		3722-003199	JACK-MODULAR;8P/8C,Y,ANGLE,NONE,AU,1PORT	1	SA
...4		3722-003457	JACK-USB;4P/1C,NI,BLK,ANGLE,A,2.0,13.1x1	2	SA
...4		3722-003814	JACK-PHONE;1P/7C,NI/SN,YEL,ANGLE,3.5PI,1	1	SA
...4	JACK	3722-003873	JACK-PHONE;1P/7C,AU/SN,BLU,ANGLE,3.5PI,1	1	SA
...4		6302-001376	GASKET-SMD;,,CONDUCTIVE FABRIC,T14,W43,L	5	SNA
...4		BN40-00330A	TUNER-DTV AIR CABLE;DTOS40EH7A,DVB-TC,38	1	SA
...4		BN41-02568A	PCB-MAIN;MU6400,FR-4,4L,1.6T,1,KANT Buil	1	SNA
...4	CB07	BN61-13312B	BRACKET-SCREWLESS PCB;55KS8000,SK5,T0.3,	4	SNA
...4		BN97-12857A	ASSY MICOM-SUB;KMMICOM_TV,UMU7000,W25Q40	1	SNA
....5		1107-002226	IC-NOR FLASH;W25Q40CLSSIP,4Mbit,SOIC,8P,	1	SA
...4		BN97-12955B	ASSY MICOM-MAIN;T-KTMDEUC,MU6100/6300,KL	1	SNA
....5		1107-002374	IC-EMMC;KLM4G1FEPD-B031,4Gbyte,BGA,153P,	1	SA
...4		BN97-12956A	ASSY MICOM;T-CON F/W KANT-M,MU6100/6300,	1	SNA
....5		1107-002339	IC-NOR FLASH;W25Q80DV,8Mbit,SOP,5.28x5.2	1	SNA
....5		BN46-00636A	S/W MICOM;KANT-M_TCON F/W	1	SNA
1		BN92-21840D	ASSY BOX;UMU6100N,43	1	SNA
.2		BH68-00662A	LABEL BOX;ALL,ART PAPER,W60,L110,WHT,NO	1	SNA
.2		BN69-16208F	BOX UNIT;43MU6100,CB,DW3,F1,L1218,W146,H	1	SNA
1		BN92-21853A	ASSY P/MATERIAL;UMU6100N,43	1	SNA
.2		0203-006958	TAPE-SINGLE FACE;OPP,T0.065,W75,L1500M,C	1	SNA
.2		6902-002731	BAG ROLL;HDPE/PE FOAM,T0.015/T0.5,W1200,	1	SNA
.2		6922-000013	BAND;PP,W18,L2300/L2900,TRP	1	SNA
.2		6932-000004	WRAP;T0.023,W750,L1000m,non stretched fi	2	SNA
.2		BN69-13583D	PAD-PACKING;LED,PAPER,T5,W50,L2100,H50,Y	1	SNA
.2		BN69-15966A	CUSHION-SET;43MU6100,EPS,16.7g/l,WHITE,W	1	SNA
..3		0103-005099	RESIN EPS;BASF303,Natural,Natural	454	SNA
.2		BN69-16366A	PALLET-WOODEN;UE43MU6100,WOOD,W1120,L124	1	SNA
.2		BN74-00008D	TAPE-SINGLE FACE;OPP,T0.05,W75,L800M,CLE	1	SNA
1	ACCE1	BN92-21859K	ASSY ACCESSORY;UMU6100N,40	1	SNA
.2	ACCE4	BN96-43186E	ASSY ACCESSORY-MANUAL;UE65MU6105KXXC	1	SNA
..3		6902-001964	BAG PE;LDPE,BIOBASED,T0.03,W200,L300,TRP	1	SNA
..3		BN68-00514K	LEAFLET-WARRANTY;comm,Samsung,W.Europe,W	1	SNA
..3		BN68-04972E	LEAFLET-REGULATORY GUIDE;ALL,SAMSUNG,W/W	1	SNA

## Exploded Views and Parts List

Level	Loc.	Part Code	Description & Specification	Qty.	SA/SNA
...3		BN68-07598A	LEAFLET-FICHE;ALL,W/P,0	1	SNA
...3		BN68-07862U	LEAFLET;TV All,EUROPE,W/P,Wireless Regul	1	SNA
...3		BN68-08446B	MANUAL USERS;MU6100,XC,W/P,EURO B5	1	SNA
.2	ACCE2	BN96-43187A	ASSY ACCESSORY-CABLE;UE65MU6100KXZT	1	SNA
...3		3709-001791	CONNECTOR-CARD SLOT;64P,0.5mm,SMD-A,AU,P	1	SA
...3	T0268	3903-001118	CBF-POWER CORD;DT,EU,Angle,2P(C7),250V,2	1	SA
...3		4301-000101	BATTERY-ALKALINE;1.5V,1650mAH,LR6,14.5x5	2	SNA
...3	EC03	BN39-02189A	GENDER CABLE;DC to RCA Cable,3P,L100,UL2	1	SA
...3	EC03	BN39-02190A	GENDER CABLE;DC to RCA Cable,2P,L100,UL2	1	SA
...3		BN59-01266A	REMOCON-SMART CONTROL;2017 TV,Samsung,14	1	SA
...3		BN68-02989A	LABEL ETC;ALL,ALL,PAPER,W30,L65,WHITE,SE	2	SNA
...3		BN68-08112A	LABEL-SECURITY;ALL,PET,T0.05,W55,L52,GLO	1	SNA
...3		BN68-08448E	LEAFLET-ACCESSORY KIT;MU6,EUROPE,W/P,W20	1	SNA
...3		BN69-13918A	BAG ACCESSORY;LDPE,0.07,L350,W500,Transp	1	SNA
...3		BN96-35528A	ASSY ACCESSORY-SCREW;JU7500,40	1	SNA
...4		6902-002474	BAG SCREW;LDPE,T0.05*,W70,L90,TRP,RECYCL	1	SNA
...4	HOLDER	BN61-09494D	HOLDER-BOLT;KU6500,SWRCH18A,BLACK,B TYPE	8	SA
1		BN92-21875B	ASSY LABEL;UMU6100N,40	1	SNA
.2		BN68-06708G	LABEL-RATING;Monitor,WW,PP,T0.161,W93,L7	1	SNA
.2		BN68-07519B	LABEL-ENERGY;ALL JORDAN,WW,PP,T0.135,W60	1	SNA
.2		BN68-08438C	LEAFLET-QUICK SETUP GUIDE;UMU6100N,W/W,W	1	SNA
1		BN95-03651A	PRODUCT LCD DP;DP,BN95-02697A,SEH ONLY	1	SA
.2		BN74-00053E	TAPE-SINGLE FACE;PAPER,3M2307,T0.14,W20,	0	SNA
.2		BN92-20328A	ASSY P/MATERIAL;CY-GK043HGAV1H,Inhouse p	1	SNA
...3		BN69-12712B	CUSHION-PANEL ESD;CY-GJ043HGAV1H /43JU60	1	SNA
...4		0103-005099	RESIN EPS;BASF303,Natural,Natural	3044	SNA
.2		BN95-02697A	PRODUCT LCD-BOE;CY-GK043HGEV1V/H,K6000,B	1	SA
...3	SCREW	6001-003075	SCREW-MACHINE;BH,+,M3,L4,ZPC(WHT),SWRCH1	4	SA
...3	M0131	BN63-00520A	GASKET-EMI;APPOLO_PAL,Conductive Fabric,	2	SNA
...3		BN68-05722A	LABEL-E PASS;POLYPROPYLENE,NON-COATING	1	SNA
...3		BN90-08331G	ASSY BACK LIGHT UNIT;2016_LCM_BLU	1	SNA
...4		BN61-12993A	SUPPORT-PLATE;Y15 LED(SAMEX ONLY),PC,V-2	9	SNA
....5		0103-005036	RESIN PC;M2407,550115,TP0003,0.8 V-0	18	SNA
....5		0103-009493	RESIN PC;LH-1070W,W92853,WT0107,V-0	10	SNA
...4		BN61-13693A	OPTICAL SHEET-MLS;Y16_KU6000_43inch_PTD8	1	SNA
...4		BN61-13695A	OPTICAL SHEET-COMPLEX;Y16_KU6000_43inch_	1	SNA
...4		BN61-13697A	OPTICAL SHEET-REFLECTOR;Y16_KU6000_43inc	1	SNA
...4		BN61-13848A	DIFFUSER PLATE;Y16_KU6K 43INCH_DIFFUSER	1	SNA
...4		BN96-41403A	ASSY FRAME P-MIDDLE;43KU6000,PC+GF10%,V-	1	SNA
....5		BN60-00735M	SPACER-PET;Y14 VNB 32,PET,L380,CLEAR,T0.	2	SNA

Level	Loc.	Part Code	Description & Specification	Qty.	SA/SNA
....5		BN60-00735N	SPACER-PET;Y14 VNB 40,PET,L470,CLEAR,T0.	2	SNA
....5		BN60-00744B	SPACER-SILICONE;Y14 F-LED SLIM(VNB CELL)	2	SNA
....5		BN60-01023C	SPACER;Y15 JU7K 50",PET,L525,CLEAR,T0.1,	2	SNA
....5		BN60-01367A	SPACER-FOAM;43KU6500,PU FOAM,L945,BLACK,	2	SNA
....5		BN60-01368A	SPACER-FOAM;43KU6500,PU FOAM,L530,BLACK,	2	SNA
....5		BN61-14122A	FRAME-MIDDLE;43KU6000,PC+GF10%,V-2,BK004	1	SNA
....6		0103-007368	RESIN PC;LS-3104G,K2495,BK0048,3.0mm V-2	80	SNA
...4		BN96-41702B	ASSY CHASSIS REAR P;43KU6000,EGI-SECC,BO	1	SNA
....5		BN02-00102B	TAPE-SINGLE FACE;FILAMENT,#8917,T0.15,W2	1	SNA
....5		BN96-41220A	ASSY LED BAR P;43inch_KU6000_BOE_L,CEM3,	4	SNA
....5		BN96-41221A	ASSY LED BAR P;43inch_KU6000_BOE_R,CEM3,	4	SNA
....5		BN96-41702A	ASSY CHASSIS REAR P;43KU6000,EGI-SECC,BO	1	SNA
....6		0203-006897	TAPE-DOUBLE FACE;Si,T1,W10,L50,WHITE	1	SNA
....6	SCREW	6001-003075	SCREW-MACHINE;BH,+,M3,L4,ZPC(WHT),SWRCH1	1	SA
....6		BN02-00040C	TAPE DOUBLE FACE;F-LED ALL,PET,T0.3,W3,L	4	SNA
....6		BN02-00303A	TAPE-DOUBLE FACE;PET,T0.2,W8,CLEAR,DOUBL	0	SNA
....6		BN02-00352E	TAPE-SINGLE FACE;PET,T0.05,W15,L50M,BLAC	0	SNA
....6		BN61-11477A	HOLDER-SOURCE PCB;Y15 JU7K SDC,ABS,BLACK	4	SNA
.....7		0103-004609	RESIN ABS;HF-0680U,K21294,BK0007,HB,High	8	SNA
....6		BN61-13015B	FRAME-CHASSIS REAR LEFT RIGHT;43KU6000,P	2	SNA
....6		BN61-13016B	FRAME-CHASSIS REAR TOP;43KU6000,PC+GF10%	1	SNA
....6		BN61-13017B	FRAME-CHASSIS REAR BOTTOM;43KU6000,PC+GF	1	SNA
.....7		0103-010898	RESIN PC;LS-3104G/G73077,Gray,GY0320,V-2	194	SNA
....6		BN62-00796A	INSULATOR-SMPS;40FTV,PC,BLACK,L265,W170,	1	SNA
....6	M0131	BN63-01079A	GASKET-EMI;DS17*,Conductive Fabric,T4,W1	4	SNA
....6		BN63-04628B	GASKET;LIME,FABRIC,T8,W11,L6.5,GRAY,high	4	SNA
....6	CC04	BN64-03275B	CHASSIS-REAR;43KU6000,EGI-SECC,-,T0.5,NA	1	SNA
.....7		BN01-00373A	STEEL;43KU6000,EGI-SECC,L1023.0,0.5mm,61	1	SNA
.....7	CB20	BN61-11982B	BRACKET-WALL;55KS7000,CR-SPCC,BLACK,"M8,	4	SNA
....6		BN96-38754A	ASSY PCB P-LED INTERFACE BOARD;43FHD,-,C	1	SNA
..3		BN96-38742B	ASSY COVER P-SOURCE PCB;43KU6000,EGI-SEC	1	SNA
...4		BN62-00794A	INSULATOR-SOURCE PCB COVER LEFT;Y15 JU6K	1	SNA
...4		BN62-00795A	INSULATOR-SOURCE PCB COVER RIGHT;Y15 JU6	1	SNA
...4		BN63-14780B	COVER-SOURCE PCB;43KU6000,EGI-SECC,T0.5,	1	SNA
..3		BN96-41364A	ASSY OPEN CELL;BOE,43Inch,New opne Cell,	1	SNA
...4		BN81-14759A	A/S-POLARIZER TFT;POLARIZER TFT,38-10032	1	SNA
...4		BN81-14760A	A/S-POLARIZER C/F;POLARIZER C/F,38-10032	1	SNA
...4		BN81-14761A	A/S-SOURCE PCB RIGHT;SOURCE PCB RIGHT,44	1	SNA
...4		BN81-14762A	A/S-SOURCE PCB LEFT;SOURCE PCB LEFT,44-9	1	SNA
...4		BN81-14763A	A/S-IC DRIVER SOURCE;IC DRIVER SOURCE,47	1	SNA

Exploded Views and Parts List

Level	Loc.	Part Code	Description & Specification	Qty.	SA/SNA
...3		BN96-41402A	ASSY CHASSIS FRONT P;43KU6000,PC+ABS+MF1	1	SA
...4		BN02-00112A	TAPE-SINGLE FACE;PET,L65.8M,T0.09,W10,RO	0	SNA
...4		BN60-00715A	SPACER-CONDUCTIVE;Y13 Slim F-LED,CONDUCT	2	SNA
...4		BN60-00930X	SPACER-CONDUCTIVE;Y15 FLED 43,CONDUCTIVE	2	SNA
...4		BN60-00930Y	SPACER-CONDUCTIVE;Y15 FLED 43,CONDUCTIVE	2	SNA
...4		BN60-01115A	SPACER-CONDUCTIVE;Y15 JU8K,CONDUCTIVE FA	3	SNA
...4		BN63-11875Q	SHEET-PROTECTION COVER;Y14 SF-LED,AL,T0.	1	SNA
...4	AS080	BN63-14373D	SHEET-AL;LED_JU7000,AL,T0.068,W30,L10000	2	SNA
...4	AC155	BN64-03634A	CHASSIS-FRONT;43KU6000,PC+ABS+MF15%,V-1,	1	SNA
....5		0103-010326	RESIN PC ABS;HRM1530F/BK00749,Black,BK00	300	SNA
.2		BN96-39823C	FFC CABLE;40KU6000,43KU6000,Fold,L600,96	1	SA
.2		BN96-39891A	FFC CABLE;55KS7500,Fold,L400,96P	1	SA