

1. QE75QN85BATXXC BA01

QE75QN85BATXXC BA01

Exploded View

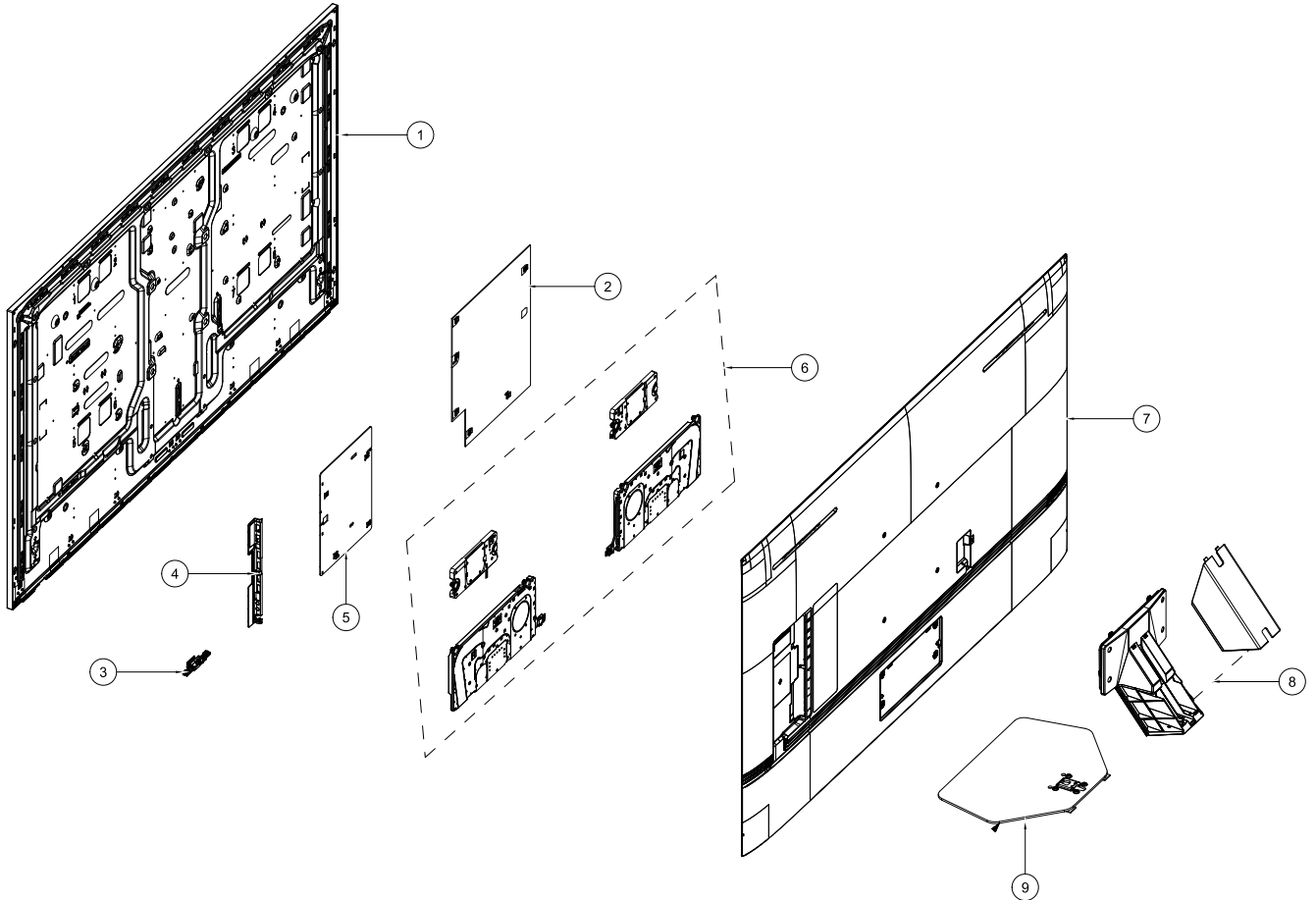

Parts List

No.	Lvl.	Loc.	Material Code	Description & Specification	SNA	Qty.
1	2	PANEL	BN95-08438A	PRODUCT LCD-BOE; CY-TB075FLEV1H/V,QN85BE,	SA	1
2	2	POWER	BN44-01168A	DC VSS-POWER BOARD; L75SA8NA_BDY,AC/DC,27	SA	1
3	2	WLAN	BN59-01396A	NETWORK-WLAN CLIENT; WCB731M,90.83x20.91x	SA	1
4	2	TERMINAL	BN63-19384B	COVER-TERMINAL SIDE; 65QAQ70F,PC+ABS,V-0,	SA	1
5	2	MAIN	BN94-17398R	ASSY PCB MAIN; QN85BE	SA	1
6	2	P-SPEAKER	BN96-53043B	ASSY SPEAKER P-FRONT; TV-SPK,75QAQN85K,2.	SA	1
7	2	P-REAR	BN96-54818E	ASSY COVER P-REAR; 75QN90BD,PC+ABS+ED20%,	SA	1

Exploded Views and Parts List

No.	Lvl.	Loc.	Material Code	Description & Specification	SNA	Qty.
8	2	P-C/NECK	BN96-54836A	ASSY STAND P-COVER NECK; 75QN85BE,PP+GF40	SA	1
9	2	P-C/TOP	BN96-54838A	ASSY STAND P-COVER TOP; 75QN85BE,HGI,Natu	SA	1

2. Electrical Parts List

Electrical Parts List

Level	Loc.	Part Code	Description & Specification	Qty.	SA/SNA
			QE75QN85BATXXC (BA01)		
1		BN90-12392L	ASSY W/I;QN85BE	1	SNA
.2		BN81-08159Z	A/S PART SET-ELEC W/I;LED TV ELEC spec-C	1	SNA
.2		BN81-20472R	A/S PART SET-MECH W/I;QN85BE,Q75BE*	1	SNA
1		BN90-12393M	ASSY COVER REAR;QN85BE	1	SNA
.2	P-REAR	BN96-54818E	ASSY COVER P-REAR;75QN90BD,PC+ABS+ED20%,	1	SA
..3	C/REAR	BN63-19299N	COVER-REAR;75QN90BD,PC+ABS+ED20%,V-0,BK0	1	SNA
...4		0103-011533	RESIN PC ABS;GC-1214A/K21294,Black,BK000	5640	SNA
..3		BN68-03518W	LABEL-STICKER CI SLOT;43UNU7090P,PET,T0.	1	SNA
1		BN90-12396H	ASSY STAND;QN85BE	1	SNA
.2	P-C/NECK	BN96-54836A	ASSY STAND P-COVER NECK;75QN85BE,PP+GF40	1	SA
..3		0203-007085	TAPE-SINGLE FACE;PET,T0.05,W20,L100M,CLE	0	SNA
..3	SCREW	6003-001239	SCREW-TAPTYPE;FH,+,B,M4,L10,ZPC(WHT),SWR	6	SA
..3		6902-003808	BAG ACCESSORY;HDPE/PE FOAM,T0.015/T0.5,W	1	SNA
..3		BN61-18411A	BRACKET-STAND NECK LEFT;75QN85BE,HGI,T2,	1	SNA
..3		BN61-18412A	BRACKET-STAND NECK RIGHT;75QN85BE,HGI,T2	1	SNA
..3		BN63-19999A	COVER-STAND NECK;75QN85BE,PP+GF40%,HB,BK	1	SNA
...4		0103-011475	RESIN PP;9500G40/9379B,Black,BK0020,HB,G	711	SNA
..3		BN63-20009A	COVER-STAND NECK REAR;75QN85BE,ABS,HB,BK	1	SNA
...4		0103-004609	RESIN ABS;HF-0680U,K21294,BK0007,HB,High	119	SNA
..3		BN96-49315B	ASSY ACCESSORY-SCREW;65QAQN90D,ALL,W/W,R	2	SNA
...4	SCREW	6003-001907	SCREW-TAPTYPE;BH,+,S,M4,L14,ZPC(BLK),SWR	8	SA
...4		6902-003608	BAG SCREW;LDPE,T0.06,W60,L80,TRP,RECYCLE	2	SNA
.2	P-C/TOP	BN96-54838A	ASSY STAND P-COVER TOP;75QN85BE,HGI,Natu	1	SA
..3		0201-003279	ADHESIVE-AA;UPUV,CLEAR	0	SNA
..3		6902-003811	BAG ACCESSORY;LDPE,T0.06,W450,L420,TRP,R	1	SNA
..3		BN63-20012A	COVER-STAND TOP;75QN85BE,HGI,T5,Natural,	1	SNA
...4		BN61-17168A	STUD-PEM;65QTQ80D,SUM24L,T2,L7,ZPC(SIL),	4	SNA
..3		BN67-00459A	FOOT-RUBBER;STAND,RUBBER,GRAY,T2	4	SNA
1	CHASSIS	BN91-23901S	ASSY CHASSIS;QN85BE	1	SNA
.2		BN46-01902A	S/W-MODEL;QBQ85,PONTUS-M,QN85BE	1	SNA
.2	MAIN	BN94-17398R	ASSY PCB MAIN;QN85BE	1	SA
..3		BN62-00843A	HEAT SINK-PS;LS003,A1050,T1.5,W60,L50,BL	1	SNA
..3		BN62-00966A	HEAT SINK-PS;KQ65QB70AFXKR,A1050,T1.5,W1	1	SNA
..3		BN97-19340W	ASSY SMD;QN85BE	1	SNA
...4		0202-001976	SOLDER-CREAM;LST-309M-K21 (PWM-118),D20~	6	SNA
...4		0401-001056	DIODE-SWITCHING;MMBD4148SE,100V,200mA,SO	1	SA

Level	Loc.	Part Code	Description & Specification	Qty.	SA/SNA
...4		0403-001779	DIODE-ZENER;MMSZ5234BT1G,5.89~6.51V,500m	1	SA
...4		0403-001783	DIODE-ZENER;BZB84-C6V2,5.8~6.6V,300mW,SO	3	SNA
...4		0403-002014	DIODE-ZENER;KDZ16B,16.2~18.3V,1000mW,SOD	2	SNA
...4		0403-002067	DIODE-ZENER;PESD5V0U1UT,7.5V,7.0/8.2V,30	1	SA
...4		0404-001404	DIODE-SCHOTTKY;BAT721C,40V,200mA,SOT-23,	2	SA
...4		0404-001640	DIODE-SCHOTTKY;SS1060HEWS,60V,1000mA,SOD	2	SA
...4		0404-001881	DIODE-SCHOTTKY;SS3040-HE,40V,3000mA,SOD-	3	SA
...4		0404-001953	DIODE-SCHOTTKY;MBRA340F-HAF,40V,3000mA,S	2	SA
...4		0404-001976	DIODE-SCHOTTKY;SV540,40V,5000mA,TO-277,T	1	SA
...4		0406-001200	DIODE-TVS;RClamp0504F,6V,1MAV,TP	4	SA
...4		0406-001290	DIODE-TVS;3.0SMCJ20A,22.2V,24.5V,5MAV,30	1	SNA
...4		0406-001568	DIODE-TVS;PESD5V0V1BL,5.8/6.8/7.8V,45W,S	3	SA
...4		0406-001635	DIODE-TVS;SMF5.0A,6.4V,6.7V,7V,200MAV,20	1	SA
...4		0406-001718	DIODE-TVS;SMF36A,40V,44.2V,3.8MAV,1.25VP	1	SA
...4		0501-000445	TR-SMALL SIGNAL;KTC3875S-Y,NPN,150mW,SOT	7	SC
...4		0501-000462	TR-SMALL SIGNAL;MMBT2907A,PNP,350mW,SOT-	2	SA
...4		0505-002560	FET-SILICON;AO6415,P,20V,-3.3A,0.15ohm,1	1	SA
...4		0505-002598	FET-SILICON;AP2317GN,P,20V,-4.2A,0.052oh	1	SA
...4		0505-002660	FET-SILICON;Si2308BDS,N,60V,2.3A,0.156oh	1	SA
...4		0505-003397	FET-SILICON;2N7002K,N,60V,0.38A,1.19ohm,	4	SA
...4		0505-003620	FET-SILICON;AOD4286,N,100V,14A,55.5mohm,	1	SA
...4		0505-003732	FET-SILICON;MMFTN123K,N,100V,0.19A,10ohm	4	SNA
...4		0505-003752	FET-SILICON;AONR21321,P,30V,50A,0.035ohm	3	SNA
...4		0801-003603	IC-CMOS LOGIC;MC74LCX244MN2TWG,Octal buf	1	SA
...4		1103-001564	IC-EEPROM;S-24C512CI-J800,512Kbit,x8,SOP	1	SA
...4		1105-003132	IC-DDR4 SDRAM;K4F2E3S4HA-MGCL,WFBGA,200P	1	SNA
...4		1105-003173	IC-DDR4 SDRAM;H54G38AYRBX259,FBGA,200P,T	1	SNA
...4		1201-004170	IC-AUDIO AMP;TAS880021A,TSSOP,48P,12.5x6	3	SA
...4		1203-008918	IC-DC/DC CONVERTER;TPS65235,WQFN,20P,3x3	1	SA
...4		1203-008921	IC-DC/DC CONVERTER;SYU236ARAC,QFN,20P,3x	1	SA
...4		1203-009186	IC-POS1.ADJUST REG.;TLV759P01PDRVR,TP,6P	1	SA
...4		1203-009193	IC-DC/DC CONVERTER;SYD113IADC,TSOT23-6,6	4	SA
...4		1203-009194	IC-DC/DC CONVERTER;SYD104IADC,TSOT23-6,6	1	SA
...4		1203-009312	IC-DC/DC CONVERTER;SYD105I,TSOT23-6,6P,2	1	SA
...4		1203-009590	IC-VOL. DETECTOR;G623AF11U,8P,TP,TP,4.9x	1	SNA
...4		1203-009643	IC-POS1.ADJUST REG.;ET5A0ADJY2B,6P,DFN6,	1	SNA
...4		1203-009647	IC-DC/DC CONVERTER;VPMS3BGM,72P,QFN,TP,8	1	SNA
...4		1203-009652	IC-DC/DC CONVERTER;MP8795HGLE-Z,21P,QFN-	1	SNA
...4		1204-003839	IC-DECODER;Quantum Processor III Neo,TR,	1	SNA
...4		1205-005519	IC-SWITCH;ET20163,SOT23-5,5P,2.95x3.02mm	3	SA

Level	Loc.	Part Code	Description & Specification	Qty.	SA/SNA
...4		1205-006382	IC-SWITCH;G2898KD1U,14P,TDFN,TP,2x3x0.75	1	SNA
...4		1404-001731	THERMISTOR-NTC;33Kohm,4050K,1MWC,TP,1.6x	1	SNA
...4		1405-001185	VARISTOR;500V,24VDC,1608,TP,150V,0.055pF	2	SA
...4		1405-001232	VARISTOR;6.4V,5.6VDC,30A,1608,TP,19V,200	2	SNA
...4		1405-001271	VARISTOR;35V,20VDC,5A,1005,TP,100V,10pF	9	SA
...4		1405-001381	VARISTOR;11V,8VDC,30A,1608,TP,25V,500pF	5	SA
...4		1405-001382	VARISTOR;24.5V,16VDC,120A,2012,TP,42V,40	1	SA
...4		1405-001452	VARISTOR;15V,12VDC,8A,1608,TP,46V,18pF	6	SA
...4		2007-000052	R-CHIP;10Kohm,1%,1/10W,TP,1608	1	SA
...4		2007-000066	R-CHIP;20Kohm,1%,1/10W,TP,1608	2	SNA
...4		2007-000070	R-CHIP;0ohm,5%,1/10W,TP,1608,T0.45	6	SA
...4		2007-000140	R-CHIP;1Kohm,5%,1/16W,TP,1005,T0.35	7	SNA
...4		2007-000171	R-CHIP;0ohm,5%,1/16W,TP,1005,T0.35	30	SNA
...4		2007-000779	R-CHIP;33ohm,1%,1/10W,TP,1608	8	SA
...4		2007-000929	R-CHIP;470ohm,1%,1/10W,TP,1608	3	SNA
...4		2007-000979	R-CHIP;5.6Kohm,1%,1/10W,TP,1608	1	SA
...4		2007-001007	R-CHIP;51Kohm,1%,1/10W,TP,1608	1	SA
...4		2007-001125	R-CHIP;68Kohm,1%,1/10W,TP,1608	2	SA
...4		2007-001292	R-CHIP;33ohm,5%,1/16W,TP,1005,T0.35	5	SNA
...4		2007-001298	R-CHIP;51ohm,5%,1/16W,TP,1005,T0.35	3	SNA
...4		2007-002899	R-CHIP;10ohm,1%,1/10W,TP,1608	48	SA
...4		2007-002906	R-CHIP;200Kohm,1%,1/10W,TP,1608	1	SA
...4		2007-003010	R-CHIP;20ohm,5%,1/16W,TP,1005	5	SA
...4		2007-007107	R-CHIP;100Kohm,1%,1/16W,TP,1005,T0.35,-	18	SNA
...4		2007-007131	R-CHIP;13Kohm,1%,1/16W,TP,1005,T0.35	2	SA
...4		2007-007132	R-CHIP;15Kohm,1%,1/16W,TP,1005,T0.35	3	SA
...4		2007-007135	R-CHIP;18Kohm,1%,1/16W,TP,1005,T0.35	3	SNA
...4		2007-007136	R-CHIP;4.7Kohm,1%,1/16W,TP,1005,T0.35	60	SNA
...4		2007-007137	R-CHIP;1.2Kohm,1%,1/16W,TP,1005,T0.35	4	SA
...4		2007-007138	R-CHIP;27Kohm,1%,1/16W,TP,1005,T0.35,Gen	1	SA
...4		2007-007139	R-CHIP;47Kohm,1%,1/16W,TP,1005,T0.35	14	SA
...4		2007-007142	R-CHIP;10Kohm,1%,1/16W,TP,1005,T0.35	42	SNA
...4		2007-007231	R-CHIP;110Kohm,1%,1/10W,TP,1608	1	SA
...4		2007-007306	R-CHIP;100ohm,1%,1/16W,TP,1005,T0.35	19	SNA
...4		2007-007307	R-CHIP;150ohm,1%,1/16W,TP,1005,T0.35	1	SNA
...4		2007-007310	R-CHIP;8.2Kohm,1%,1/16W,TP,1005,T0.35	3	SA
...4		2007-007311	R-CHIP;22Kohm,1%,1/16W,TP,1005,T0.35	4	SA
...4		2007-007312	R-CHIP;20Kohm,1%,1/16W,TP,1005,T0.35	8	SA
...4		2007-007313	R-CHIP;6.8Kohm,1%,1/16W,TP,1005,T0.35	5	SA
...4		2007-007316	R-CHIP;3.3Kohm,1%,1/16W,TP,1005,T0.35	6	SA

Exploded Views and Parts List

Level	Loc.	Part Code	Description & Specification	Qty.	SA/SNA
...4		2007-007318	R-CHIP;1Kohm,1%,1/16W,TP,1005,T0.35	18	SNA
...4		2007-007488	R-CHIP;75Kohm,1%,1/16W,TP,1005,T0.35	1	SA
...4		2007-007517	R-CHIP;240ohm,1%,1/16W,TP,1005,T0.35	4	SNA
...4		2007-007520	R-CHIP;20ohm,1%,1/10W,TP,1608	20	SA
...4		2007-007538	R-CHIP;56Kohm,1%,1/16W,TP,1005,T0.35	1	SA
...4		2007-007588	R-CHIP;1.8Kohm,1%,1/16W,TP,1005,T0.3	3	SA
...4		2007-007671	R-CHIP;11Kohm,1%,1/16W,TP,1005,T0.35	1	SA
...4		2007-007698	R-CHIP;5.1Kohm,1%,1/16W,TP,1005,T0.35	1	SNA
...4		2007-007736	R-CHIP;510Kohm,1%,1/10W,TP,1608	1	SA
...4		2007-007766	R-CHIP;2Kohm,1%,1/16W,TP,1005,T0.35	21	SNA
...4		2007-007767	R-CHIP;200ohm,1%,1/16W,TP,1005	8	SA
...4		2007-007791	R-CHIP;9.1Kohm,1%,1/16W,TP,1005,T0.35	1	SNA
...4		2007-007798	R-CHIP;10ohm,1%,1/16W,TP,1005,T0.35	8	SA
...4		2007-007992	R-CHIP;1ohm,1%,1/10W,TP,1608	2	SA
...4		2007-008015	R-CHIP;75ohm,1%,1/16W,TP,1005,T0.35	1	SA
...4		2007-008026	R-CHIP;56ohm,1%,1/16W,TP,1005,T0.35	1	SA
...4		2007-008136	R-CHIP;36Kohm,1%,1/16W,TP,1005	1	SA
...4		2007-008137	R-CHIP;24Kohm,1%,1/16W,TP,1005,T0.35	1	SNA
...4		2007-008263	R-CHIP;3Kohm,1%,1/16W,TP,1005,T0.35	2	SA
...4		2007-008269	R-CHIP;51Kohm,1%,1/16W,TP,1005,T0.35	1	SNA
...4		2007-008275	R-CHIP;30Kohm,1%,1/16W,TP,1005,T0.35	3	SNA
...4		2007-008294	R-CHIP;33ohm,1%,1/16W,TP,1005,T0.35	16	SA
...4		2007-008298	R-CHIP;49.9ohm,1%,1/16W,TP,1005,T0.35	13	SA
...4		2007-008596	R-CHIP;0.1ohm,1%,1/4W,TP,3216	3	SC
...4		2007-008779	R-CHIP;0ohm,5%,1/16W,TP,1005,T0.35,Gener	1	SA
...4		2011-001261	R-NETWORK;33ohm,5%,1/16W,L,CHIP,8P,TP,2.	6	SA
...4		2011-001264	R-NETWORK;10ohm,5%,1/16W,L,CHIP,8P,TP,2.	8	SNA
...4		2011-001344	R-NETWORK;100ohm,5%,1/16W,L,CHIP,8P,TP,2	9	SA
...4		2011-001527	R-NETWORK;4.7Kohm,5%,1/16W,L,CHIP,4P,TP,	3	SNA
...4		2011-001587	R-NETWORK;100ohm,5%,1/16W,L,CHIP,4P,TP,1	1	SNA
...4	AD480	2203-000233	C-CER,CHIP;100pF,5%,50V,C0G,TP,1005,T0.5	12	SA
...4	AD480	2203-000278	C-CER,CHIP;10pF,0.5pF,50V,C0G,TP,1005,-5	2	SA
...4	AD480	2203-000359	C-CER,CHIP;150pF,5%,50V,C0G,TP,1005,T0.5	6	SA
...4	AD480	2203-000425	C-CER,CHIP;18pF,5%,50V,C0G,TP,1005,-55to	2	SA
...4	AD480	2203-000438	C-CER,CHIP;1nF,10%,50V,X7R,TP,1005,T0.5,	6	SA
...4	AD480	2203-000489	C-CER,CHIP;2.2nF,10%,50V,X7R,TP,1005,T0.	1	SA
...4	AD480	2203-000812	C-CER,CHIP;33pF,5%,50V,C0G,TP,1005,-55to	14	SA
...4	AD480	2203-000940	C-CER,CHIP;470pF,10%,50V,X7R,TP,1005,T0.	3	SA
...4	AD480	2203-002285	C-CER,CHIP;10nF,10%,50V,X7R,TP,1005,-55t	22	SNA
...4	AD480	2203-002525	C-CER,CHIP;560pF,10%,50V,X7R,TP,1005,-55	1	SNA

Level	Loc.	Part Code	Description & Specification	Qty.	SA/SNA
...4	AD480	2203-005083	C-CER,CHIP;220nF,10%,50V,X7R,TP,1608,T0.	24	SA
...4	AD480	2203-005642	C-CER,CHIP;220pF,5%,50V,C0G,TP,1005,T0.5	1	SNA
...4	AD480	2203-006048	C-CER,CHIP;100nF,10%,10V,X7R,TP,1005,T0.	1	SA
...4	AD480	2203-006158	C-CER,CHIP;100nF,10%,16V,X7R,TP,1005,T0.	61	SNA
...4	AD480	2203-006377	C-CER,CHIP;4.7uF,10%,25V,X5R,TP,2012,-55	1	SNA
...4	AD480	2203-006562	C-CER,CHIP;1uF,10%,10V,X5R,TP,1005,T0.5,	9	SNA
...4	AD480	2203-006698	C-CER,CHIP;1uF,10%,25V,X7R,TP,1608,T0.8,	13	SA
...4	AD480	2203-006841	C-CER,CHIP;1uF,10%,16V,X5R,TP,1005,T0.5,	35	SNA
...4	AD480	2203-006844	C-CER,CHIP;470nF,10%,10V,X5R,TP,1005,-55	2	SA
...4	AD480	2203-007176	C-CER,CHIP;10uF,10%,16V,X5R,TP,2012,T1.2	6	SNA
...4	AD480	2203-007230	C-CER,CHIP;47uF,20%,6.3V,X5R,TP,2012,T1.	7	SNA
...4	AD480	2203-007240	C-CER,CHIP;22uF,20%,6.3V,X5R,TP,1608,T0.	68	SA
...4	AD480	2203-007269	C-CER,CHIP;22uF,20%,10V,X5R,TP,2012,T0.8	13	SA
...4	AD480	2203-007271	C-CER,CHIP;2.2uF,10%,10V,X5R,TP,1005,T0.	6	SNA
...4	AD480	2203-007306	C-CER,CHIP;10uF,10%,25V,X5R,TP,2012,T1.2	27	SNA
...4	AD480	2203-007393	C-CER,CHIP;4.7uF,10%,10V,X5R,TP,1005,T0.	8	SNA
...4	AD480	2203-007423	C-CER,CHIP;10uF,10%,35V,X7R,TP,3216,-55t	7	SA
...4	AD480	2203-007544	C-CER,CHIP;100nF,10%,50V,X7R,TP,1005,T0.	30	SA
...4	AD480	2203-007795	C-CER,CHIP;10uF,20%,10V,X5R,TP,1005,T0.5	6	SA
...4	AD480	2203-007809	C-CER,CHIP;22nF,10%,50V,X7R,TP,1005,T0.5	1	SNA
...4	AD480	2203-008315	C-CER,CHIP;22uF,20%,25V,X5R,TP,2012,T1.2	12	SA
...4	AD480	2203-008412	C-CER,CHIP;4.7uF,10%,50V,X5R,TP,2012,T1.	1	SNA
...4		2409-001240	C-ORGANIC,SMD;33uF,20%,25V,LR,TP,7343	1	SA
...4		2703-000213	INDUCTOR-SMD;470nH,10%,1608,T0.8,1.35Ohm	3	SA
...4		2703-002269	INDUCTOR-SMD;56nH,5%,1005,T0.5,1Ohm,200m	7	SA
...4		2703-003747	INDUCTOR-SMD;22uH,20%,6060,0.135ohm,1300	2	SA
...4		2703-003862	INDUCTOR-SMD;10uH,20%,6060,0.065ohm,1900	4	SA
...4		2703-004724	INDUCTOR-SMD;8.2uH,20%,5050,T4,0.072Ohm,	12	SA
...4		2703-005191	INDUCTOR-SMD;1.5uH,20%,6060,T4.5,0.02Ohm	3	SA
...4		2703-005193	INDUCTOR-SMD;2.2uH,20%,6060,T4.5,0.024Oh	2	SA
...4		2703-005194	INDUCTOR-SMD;3.3uH,20%,6060,T4.5,0.03Ohm	1	SA
...4		2703-005376	INDUCTOR-SMD;10uH,20%,10.7x10mm,T3.8,0.0	1	SA
...4		2703-005780	INDUCTOR-SMD;10uH,20%,2012,T1.25,0.91Ohm	2	SNA
...4		2703-005781	INDUCTOR-SMD;220nH,20%,7876,T2.9,0.00176	1	SNA
...4		2703-005843	INDUCTOR-SMD;1uH,20%,6060,T2.6,0.0156Ohm	1	SNA
...4		2801-004021	CRYSTAL-SMD;24.576MHz,20ppm,28-AAN,12pF,	1	SA
...4		3301-001364	BEAD-SMD;1000ohm/100Mhz,1.6x0.8mm,TP,139	4	SNA
...4		3301-002039	BEAD-SMD;26ohm/100Mhz,1.6X0.8mm,TP,7mohm	29	SA
...4		3601-001374	FUSE-SURFACE MOUNT;32V,5A,FAST-ACTING,PL	5	SA
...4		3601-001376	FUSE-SURFACE MOUNT;32V,3A,FAST-ACTING,Hi	1	SNA

Exploded Views and Parts List

Level	Loc.	Part Code	Description & Specification	Qty.	SA/SNA
...4		3701-002024	CONNECTOR-HDMI;19P,A,FEMALE,AU,0.5mm,BLK	4	SA
...4		3707-001143	CONNECTOR-OPTICAL;ANGLE,SPDIF,Waveless,2	1	SA
...4		3708-003241	CONNECTOR-FPC/FFC/PIC;96P,0.5mm,SMD-A,AU	1	SA
...4		3708-003355	CONNECTOR-FPC/FFC/PIC;TP,SMD-A,24P,0.5mm	2	SNA
...4		3710-003908	CONNECTOR-SOCKET;64P,2R,0.5mm,SMD-S,AU,B	1	SA
...4		3711-008131	HEADER-BOARD TO CABLE;BOX,4P,1R,2.5mm,AN	1	SA
...4		3711-008488	HEADER-BOARD TO CABLE;BOX,14P,2R,2mm,ANG	1	SA
...4		3711-009106	CONNECTOR-HEADER;BOX,20P,2R,2mm,ANGLE,SN	1	SA
...4		3722-003199	JACK-MODULAR;8P/8C,Y,ANGLE,NONE,AU,1PORT	1	SA
...4		3722-003457	JACK-USB;4P/1C,NI,BLK,ANGLE,A,2.0,13.1x1	2	SA
...4		6302-001376	GASKET-SMD;SMT Gasket,Si,T6,W4.5,L2.5,SI	7	SNA
...4		BN40-00343A	TUNER-DTV AIR CABLE SAT;GT2S2-21D31,DVB-	1	SA
...4		BN41-03014A	PCB-MAIN;Q70B, Q7N5B, QN85B, QN90B,FR-4,	1	SNA
...4		BN61-13312B	BRACKET-SCREWLESS PCB;55KS8000,SK5,T0.3,	4	SNA
...4		BN97-19547A	ASSY MICOM;TCON MICOM,QN90B,QN85B,Q70B,1	1	SNA
...5		1107-002851	IC-NOR FLASH;GD25Q40ESIGY,SOP,8P,TR,7.9x	2	SNA
...4		BN97-19549A	ASSY MICOM;PTMMICOM_INTV,QN90B,QN85B,Q70	1	SNA
...4		BN97-19712A	ASSY MICOM;QN85B,T-PTMDEUC	1	SNA
...5		1107-002688	IC-EMMC;THGBMJG6C1LBAIL,8Gbit,64Gbx1,BGA	1	SNA
...3		BN97-19554A	ASSY DRM;PONTUS-M,DVB,NagSam, MAC, HDCP,	1	SNA
...4		BN46-00109H	KEY CODE-CERTIFICATION;MAC,TV/AV,General	1	SNA
...4		BN46-00110P	KEY CODE-CERTIFICATION;MIRACAST(HDCP2.2)	1	SNA
...4		BN46-01862A	KEY CODE;22Y_Pontus-M,Pontus-M_2-DVB,DVB	1	SNA
...4		BN46-01864A	KEY CODE;22Y_Pontus-M,PONTUS-M_22,Samsun	1	SNA
...4		BN46-01865A	KEY CODE;22Y_Pontus-M,PONTUS-M_ECP_22,Sa	1	SNA
...3		BN97-19745A	ASSY MICOM;75QN85B	1	SNA
...4		BN46-01954A	S/W;75QN85B,COMMON DATA	1	SNA
1		BN91-23904H	ASSY SHIELD;QN85BE	1	SNA
.2	SCREW	6003-001912	SCREW-TAPTYPE;CH,+,B,M3,L4,ZPC(BLK),SWRC	2	SNA
.2		BN02-00102B	TAPE-SINGLE FACE;OPP,T0.15,W25,L50M,WHIT	0	SNA
.2		BN39-02207N	LEAD CONNECTOR-POWER;QN65QN85AAFZXZ,UL21	1	SA
.2	POWER	BN44-01168A	DC VSS-POWER BOARD;L75SA8NA_BDY,AC/DC,27	1	SA
.2	WLAN	BN59-01396A	NETWORK-WLAN CLIENT;WCB731M,90.83x20.91x	1	SA
.2	TERMINAL	BN63-19384B	COVER-TERMINAL SIDE;65QAQ70F,PC+ABS,V-0,	1	SA
...3		0103-005041	RESIN PC ABS;FR3200TV/901408,Black,BK000	14	SNA
.2		BN68-09258E	LABEL ETC;ALL MODEL,PET,T0.05,W40,L40,YW	1	SNA
.2		BN96-39820K	FFC;QN65QN85AAFZXZ,Fold,L500,96P	1	SA
.2	P-SPEAKER	BN96-53043B	ASSY SPEAKER P-FRONT;TV-SPK,75QAQN85K,2.	1	SA
.2		BN96-53245A	FFC;QN75QN85AAFZXZ,Fold,L400,24P	1	SA
.2		BN96-54953A	FFC;75QN90B,Fold,L600,24P,MAIN-FUNCTION,	1	SA

Level	Loc.	Part Code	Description & Specification	Qty.	SA/SNA
1		BN92-30913C	ASSY LABEL;QN85BE	1	SNA
.2		BN68-06708G	LABEL-RATING;ALL,WW,PP,T0.1,W93,L73,Dark	1	SNA
.2		BN68-11432A	LABEL-ENERGY;EU,PP,T0.1,W96,L192,INBOX	1	SNA
.2		BN68-11433A	LABEL-ENERGY;EU,ART,T0.1,W96,L192,BOX	1	SNA
.2		BN68-13695A	LEAFLET-QUICK SETUP GUIDE;QN85B(75 85),O	1	SNA
1		BN92-30914J	ASSY BOX;QN85BE	1	SNA
.2		BH68-00662A	LABEL BOX;ALL,ART,W60,L110,WHT,NO SILK,9	1	SNA
.2		BN69-23436D	BOX UNIT-OUT;75QN85BE,CB,DW4,F3,L1862,W1	1	SNA
1		BN92-30916A	ASSY P/MATERIAL;QN85BE	1	SNA
.2		6902-003492	BAG ROLL;HDPE/PE FOAM,T0.015/T1,W2000,L3	2	SNA
.2		6922-000421	BAND;PP,T0.8,W18,L2300,TRP,Recycled PIR_	6	SNA
.2		6932-000004	WRAP;T0.023,W750,L1000m,non stretched fi	5	SNA
.2		BN02-00319B	TAPE-SINGLE FACE;OPP,T0.05,W75,L800M,CLE	2	SNA
.2		BN69-13346A	PACKING SHEET;J5500 55",LDPE,T0.07,W2400	0	SNA
.2		BN69-17449F	PAD PACKING;LED,PAPER,T3,W50X50,L2300,YE	0	SNA
.2		BN69-22256C	PAD-AIR CUSHION;75QAQ60G,LDPE,T0.2,W530,	1	SNA
.2		BN69-22276F	PAD-SHEET;75QAQ60G,PET,T3.2,W70,L936,WHI	0	SNA
.2		BN69-22414A	PALLET-WOODEN;QE75QN800A,WOOD,W1180,L188	0	SNA
.2		BN69-23252A	CUSHION-SET SIDE;75QN85BE,EPS,16.7g/l,WH	1	SNA
..3		0103-005099	RESIN EPS;BASF303/NP,Natural,Natural,HB	253	SNA
.2		BN96-54987A	ASSY PACKING P-CUSHION SET;QE75QN85B,EPS	1	SNA
..3		0203-000435	TAPE-OPP;OPP,OPP,T0.07,W50,N/A,YELLOW	1	SNA
..3		BN69-23251A	CUSHION-SET;75QN85BE,EPS,16.7g/l,WHITE	1	SNA
...4		0103-005099	RESIN EPS;BASF303/NP,Natural,Natural,HB	1436	SNA
..3		BN69-23437A	BOX UNIT-IN;75QN85BE,CB,DW2,C1,L2198,W51	1	SNA
1	ACC	BN92-30918Z	ASSY ACCESSORY;QN85BE	1	SNA
.2		BN96-51312U	ASSY ACCESSORY MANUAL CABLE;QN85BE	1	SNA
..3	C/SLOT	3709-001791	CONNECTOR-CARD SLOT;64P,0.5mm,SMD-A,AU,P	1	SA
..3		3903-001130	POWER CORD-DT;EUR,2P-F,250V,2.5A,BLK,L30	1	SA
..3		6902-003503	BAG ACCESSORY;LDPE,T0.07,W480,L300,TRP,R	1	SNA
..3		BN59-01385B	REMOCON-ECO SMART CONTROL;2022 TV,SAMSUN	1	SA
..3		BN68-00514K	LEAFLET-WARRANTY;comm,Samsung,W.Europe,W	1	SNA
..3		BN68-02989A	LABEL ETC;ALL MODEL,ALL,ART,W65,L30,65X3	1	SNA
..3		BN68-08112A	LABEL-SECURITY;ALL,PET,T0.05,W55,L52,GLO	1	SNA
..3		BN68-09371B	LEAFLET-REGULATORY GUIDE;QT/UT,W/W,MOJO,	1	SNA
..3		BN68-13657B	MANUAL USERS;4K(BU8000-QN90B),XC,SPAIN,M	1	SNA
..3		BN68-13841G	LEAFLET-REMOTE CONTROL;QLED ALL,XC,SPAIN	1	SNA
1		BN92-30954B	ASSY LABEL POP;QN95BC	1	SNA
.2		BN68-14180B	LABEL POP-HIGHLIGHT;QN95B,EUROPE,PET,T0.	1	SNA
1		BN95-08630A	PRODUCT LCD DP;DP,BN95-08438A,CY-TB075FL	1	SA

Exploded Views and Parts List

Level	Loc.	Part Code	Description & Specification	Qty.	SA/SNA
.2		BN92-31141A	ASSY P/MATERIAL;CY-TB075FLEV1H	1	SNA
...3		0203-006893	TAPE-SINGLE FACE;OPP,T0.05,W100,L50M,CLE	1	SNA
...3		0204-008185	SILICAGEL;Calcium chloride,CaCl2,94%,20g	1	SNA
...3		BN69-20837A	PALLET-WOODEN;75" inhouse LCM,EUR type,W	0	SNA
...3		BN69-21956B	CUSHION-PANEL;75QAQN90D,EPS,20g/l,WHITE,	0	SNA
.2	PANEL	BN95-08438A	PRODUCT LCD-BOE;CY-TB075FLEV1H/V,QN85BE,	1	SA
...3		6001-003433	SCREW-MACHINE;SWRCH18A,ZPC(WHT),L8,M3,CH	13	SA
...3		BN63-00520A	GASKET-EMI;APPOLO_PAL,FABRIC,T0.13,W10,L	2	SNA
...3		BN68-05722A	LABEL-E PASS;PP,NON-COATING	1	SNA
...3		BN90-12375A	ASSY BACK LIGHT UNIT;QN85BE	1	SNA
...4		BN61-17827A	OPTICAL SHEET-COMPLEX;21Y_Q85A_75INCH_CO	1	SA
...4		BN61-17828A	OPTICAL SHEET-HIGH COLOR;21Y_Q85A_75INCH	1	SNA
...4		BN61-17853A	DIFFUSER PLATE;21Y_Q90A_75INCH_DP,PS,PS+	1	SNA
...4		BN96-52921A	ASSY FRAME P-MIDDLE BOTTOM;75QAQN85K,PC+	1	SA
....5		0203-007235	TAPE-DOUBLE FACE;PU FOAM,T1.4,W3.2,N/A,B	2	SNA
....5		BN60-01661A	SPACER-FABRIC;CONDUCTIVE FABRIC,L20,GRAY	2	SNA
....5		BN61-17605A	FRAME-MIDDLE BOTTOM;75QAQN90D,PC+GF10%,V	1	SNA
....6		0103-007368	RESIN PC;LS-3104G/K2495,K2495,BK0048,V-2	59	SNA
...4		BN97-19451A	ASSY SMD BIN-Q85B 75 SMD (LONG);Q85B/Q75	10	SNA
....5		0201-003554	ADHESIVE-SILICON;B,CLEAR	29	SNA
....5		0201-003555	ADHESIVE-SILICON;A,CLEAR	3	SNA
....5		0202-001608	SOLDER-WIRE FLUX;LFC7-107,D0.8,99.3Sn/0.	0	SNA
....5		0202-001830	SOLDER-CREAM;PFM-48W LT-SH,D20~38um,96.5	9	SNA
....5		0202-001976	SOLDER-CREAM;LST-309M-K21 (PWM-118),D20~	4	SNA
....5		0202-002133	SOLDER-CREAM;M705-SVD1 Type5,D15~25um,96	24	SNA
....5		0406-001729	DIODE-TVS;PESD12VV1BL,14.6V,15.7V,16.8V,	90	SNA
....5		0406-001778	DIODE-TVS;PUSB3FR4,6V,9V,0.2MAV,0.7VPA,0	30	SA
....5		0406-001823	DIODE-TVS;PJUSB208,85V,0.1MAV,0.715VPA,2	60	SA
....5		0601-003966	LED-BIN;SMD(TOP VIEW),BLU,water diff.,0x	10800	SNA
....5		1003-003246	IC-LED DRIVER;SDP21822,18P,WLP,TP,1.85x1	150	SNA
....5		2007-000039	R-CHIP;0ohm,1%,1/10W,TP,1608	10	SA
....5	AD480	2203-006698	C-CER,CHIP;1uF,10%,25V,X7R,TP,1608,T0.8,	20	SA
....5	AD480	2203-008412	C-CER,CHIP;4.7uF,10%,50V,X5R,TP,2012,T1.	80	SNA
....5		3708-003073	CONNECTOR-FPC/FFC/PIC;51P,0.5mm,SMD-A,AU	10	SA
....5		BN41-02978A	PCB-LED MODULE;Q90B 75inch,FR-4,2L,T0.6,	10	SNA
....5		BN61-17865A	SUPPORT-PLATE;65QAQN800B,PA66,V-0,WHITE,	240	SNA
...3		BN91-21714F	ASSY OPEN CELL-DECORATION;BN63-16438A,Y2	1	SNA
...4		0201-003164	ADHESIVE-UV;190024,CLEAR,UV, Acrylic	5	SNA
...4	C/DECO	BN63-16438A	COVER-DECORATION;75Q7F,STS304,T0.15,BLAC	1	SNA
...4		BN96-50413A	ASSY OPEN CELL;BOE,75Inch,Y20 New,HV750Q	1	SNA

Level	Loc.	Part Code	Description & Specification	Qty.	SA/SNA
....5		BN81-20482A	A/S-IC DRIVER SOURCE;IC DRIVER SOURCE,47	1	SA
....5		BN81-20483A	A/S-ASSY PCB-SOURCE RIGHT;ASSY PCB-SOURC	1	SNA
....5		BN81-20484A	A/S-ASSY PCB-SOURCE MIDDLE;ASSY PCB-SOUR	1	SNA
....5		BN81-20485A	A/S-ASSY PCB-SOURCE LEFT;ASSY PCB-SOURCE	1	SNA
....5		BN81-20486A	A/S-POLARIZER-C/F;POLARIZER-C/F,38-10082	1	SNA
....5		BN81-20487A	A/S-POLARIZER-TFT;POLARIZER-TFT,38-10082	1	SNA
..3		BN96-54801A	ASSY CHASSIS FRONT P;75QN85BE,AI,ANODIZN	1	SNA
...4		0203-007235	TAPE-DOUBLE FACE;PU FOAM,T1.4,W3.2,N/A,B	4	SNA
...4		6001-002912	SCREW-MACHINE;CH,+,M3,L3,ZPC(BLK),SWRCH1	2	SA
...4		BN02-00074G	TAPE SINGLE FACE;QAQN85K,PET,T0.05,W10,L	4	SNA
...4		BN60-01662A	SPACER-FABRIC;CONDUCTIVE FABRIC,L1000,GR	2	SNA
...4		BN60-01687A	SPACER-FOAM;PU FOAM,L12.5,BLACK,T1.5,W12	2	SNA
...4		BN63-17244E	SHEET-PROTECTION COVER;43Q90A,PO,T0.06,W	4	SNA
...4		BN64-04540B	CHASSIS-FRONT BOTTOM;75QN90BD,PC+GF10%,V	1	SNA
....5		0103-007368	RESIN PC;LS-3104G/K2495,K2495,BK0048,V-2	45	SNA
...4	CH/FRONT	BN64-04653A	CHASSIS-FRONT;75QN85BE,AI,BRIGHT SILVER,	1	SNA
..2	REAR-P	BN96-54805E	ASSY CHASSIS REAR P;75QN85BE,EGI-SECC,wi	1	SNA
..3		BN02-00352B	TAPE-SINGLE FACE;PET,T0.05,W30,L50M,BLAC	1	SNA
..3		BN39-02761A	LEAD CONNECTOR-DIMMING;QN65QN85AAFZA,UL	1	SA
..3	REAR-P	BN96-54805B	ASSY CHASSIS REAR P;75QN85BE,EGI-SECC	1	SNA
...4		0201-003144	ADHESIVE-AA;BP-222, YEL	0	SNA
...4		6001-003424	SCREW-MACHINE;SWRCH18A,ZPC(BLK),L2,M3,CH	46	SA
...4		BN02-00102B	TAPE-SINGLE FACE;OPP,T0.15,W25,L50M,WHIT	1	SNA
...4		BN02-00586C	TAPE DOUBLE FACE;TU7000,ACRYL,T0.3,W3,L1	2	SNA
...4		BN60-00162X	SPACER-FOAM;PE FOAM,L50M,GRAY,T1,W15	0	SNA
...4		BN60-01459A	SPACER-SILICONE;55PMF,Si,L10,WHITE,T1.8,	6	SNA
...4		BN61-13557C	BRACKET-WIRE;55KS7000,SW-C,T1,SILVER,ZIN	2	SNA
...4		BN61-13557E	BRACKET-WIRE;49KS7000,SW-C,T1,NATURAL,ZI	2	SA
...4		BN61-13557M	BRACKET-WIRE;75QM7000,SW-C,T1,SILVER,ZIN	2	SA
...4		BN61-13557P	BRACKET-WIRE;75QNQ8CB,SW-C,T1,SILVER,L66	3	SNA
...4		BN61-17597A	FRAME-CHASSIS REAR TOP;75QAQN90D,PC+GF10	1	SNA
....5		0103-011284	RESIN PC;LS-3104G/FW9931,White,WT0134,V-	218	SNA
...4		BN61-17598A	FRAME-CHASSIS REAR BOTTOM;75QAQN90D,PC+G	1	SNA
...4		BN61-17599A	FRAME-CHASSIS REAR LEFT RIGHT;75QAQN90D,	2	SNA
...4		BN61-17740A	HOLDER-SOURCE PCB;65QAQN90D,ABS,BK0007,H	6	SNA
....5		0103-004609	RESIN ABS;HF-0680U,K21294,BK0007,HB,High	5	SNA
...4	H/REAR	BN61-17922B	HOLDER-REAR;65QAQ60G,PC+GF10%,T3,WHITE,V	1	SNA
....5		0103-010237	RESIN PC;LS-3104G/W95265,White,WT0044,V-	0	SNA
...4		BN61-18562A	OPTICAL SHEET-REFLECTOR;22Y_Q95B_75INCH_	2	SNA
...4		BN61-18563A	OPTICAL SHEET-REFLECTOR;22Y_Q95B_75INCH_	1	SNA

Level	Loc.	Part Code	Description & Specification	Qty.	SA/SNA
...4		BN63-19619A	INSULATOR-SMPS;65QAQ90D,PC,BLACK,L383,W3	1	SNA
...4		BN63-19678A	INSULATOR-SOURCE PCB;75QAQN85K,PET,BLACK	2	SNA
...4		BN63-20136A	INSULATOR-LED PCB;75QN90BD,OPP,WHITE,L91	1	SNA
...4		BN63-20137A	INSULATOR-LED PCB;75QN90BD,OPP,WHITE,L73	1	SNA
...4	CH/REAR	BN64-04553A	CHASSIS-REAR;75QAQN90D,EGI-SECC,T1,NATUR	1	SNA
....5		BN01-00703A	STEEL;Y21,EGI-SECC,L0,1mm,1000mm,AG	13	SNA
....5	B/WALL	BN61-11982B	BRACKET-WALL;65MU8000,CR-SPCC,NATURAL,M8	4	SNA
....5	B/WALL	BN61-15737C	BRACKET-WALL;65QAQN90D,CR-SPCC,T1,NATURA	4	SNA
...4		BN74-00053E	TAPE-SINGLE FACE;PAPER,3M2307,T0.14,W20,	0	SNA
...4		BN94-17426A	ASSY PCB MAIN SUBCON;Q90B,Q85B,Q75B,4K 7	1	SA
....5		BN81-21036A	A/S-AIR CUSHION;AIRCAP,ESD,LDPE, AM Boar	1	SNA
....5		BN97-19370A	ASSY SMD;Q90B,Q85B,Q75B,Y22_4K_75_Q85_AM	1	SNA
....6		0202-001976	SOLDER-CREAM;LST-309M-K21 (PWM-118),D20~	2	SNA
....6		0404-001640	DIODE-SCHOTTKY;SS1060HEWS,60V,1000mA,SOD	5	SA
....6		0406-001317	DIODE-TVS;SMAJ14A,15.6V,17.2V,1MAV,6.5VP	1	SNA
....6		0406-001718	DIODE-TVS;SMF36A,40V,44.2V,3.8MAV,1.25VP	1	SA
....6		0406-001778	DIODE-TVS;PUSB3FR4,6V,9V,0.2MAV,0.7VPA,0	3	SA
....6		0505-002660	FET-SILICON;Si2308BDS,N,60V,2.3A,0.156oh	1	SA
....6		0505-003732	FET-SILICON;MMFTN123K,N,100V,0.19A,10ohm	5	SNA
....6		0505-003752	FET-SILICON;AONR21321,P,30V,50A,0.035ohm	1	SNA
....6		1003-003247	IC-LED DRIVER;SDP21823,100P,QFP,TP,14x14	5	SNA
....6		1201-004368	IC-OP AMP;LV358G-S08-R,SOP-8,8P,TP,3.95x	1	SNA
....6		1203-009063	IC-DC/DC CONVERTER;VPM2SM,QFN,56P,7x7x0.	1	SA
....6		1203-009643	IC-POSI.ADJUST REG.;ET5A0ADJY2B,6P,DFN6,	1	SNA
....6		1301-002316	IC-FPGA;XC7A50T-1CSG324C,BGA,324P,TR,15x	1	SNA
....6		1405-001232	VARISTOR;6.4V,5.6VDC,30A,1608,TP,19V,200	4	SNA
....6		2007-000138	R-CHIP;100ohm,5%,1/16W,TP,1005,T0.35	12	SA
....6		2007-000157	R-CHIP;47Kohm,5%,1/16W,TP,1005,T0.35	11	SNA
....6		2007-000172	R-CHIP;10ohm,5%,1/16W,TP,1005,T0.35	24	SNA
....6		2007-000633	R-CHIP;270Kohm,1%,1/10W,TP,1608	2	SNA
....6		2007-001068	R-CHIP;6.8Kohm,1%,1/10W,TP,1608	5	SA
....6		2007-001284	R-CHIP;4.7ohm,5%,1/16W,TP,1005,T0.35	2	SNA
....6		2007-001292	R-CHIP;33ohm,5%,1/16W,TP,1005,T0.35	20	SNA
....6		2007-001298	R-CHIP;51ohm,5%,1/16W,TP,1005,T0.35	9	SNA
....6		2007-002768	R-CHIP;6.2Kohm,1%,1/10W,TP,1608	5	SA
....6		2007-002796	R-CHIP;510ohm,5%,1/16W,TP,1005,T0.35	1	SA
....6		2007-007107	R-CHIP;100Kohm,1%,1/16W,TP,1005,T0.35,-	5	SNA
....6		2007-007135	R-CHIP;18Kohm,1%,1/16W,TP,1005,T0.35	2	SNA
....6		2007-007136	R-CHIP;4.7Kohm,1%,1/16W,TP,1005,T0.35	11	SNA
....6		2007-007142	R-CHIP;10Kohm,1%,1/16W,TP,1005,T0.35	11	SNA

Level	Loc.	Part Code	Description & Specification	Qty.	SA/SNA
....6		2007-007308	R-CHIP;33Kohm,1%,1/16W,TP,1005,T0.35	8	SA
....6		2007-007311	R-CHIP;22Kohm,1%,1/16W,TP,1005,T0.35	2	SA
....6		2007-007317	R-CHIP;2.2Kohm,1%,1/16W,TP,1005,T0.35	1	SA
....6		2007-007528	R-CHIP;1.5Kohm,1%,1/16W,TP,1005,T0.35	19	SA
....6		2007-008596	R-CHIP;0.1ohm,1%,1/4W,TP,3216	1	SC
....6	AD480	2203-000627	C-CER,CHIP;22pF,5%,50V,C0G,TP,1005,T0.5,	2	SNA
....6	AD480	2203-006158	C-CER,CHIP;100nF,10%,16V,X7R,TP,1005,T0.	12	SNA
....6	AD480	2203-006257	C-CER,CHIP;470nF,10%,6.3V,X5R,TP,1005,T0	23	SA
....6	AD480	2203-006378	C-CER,CHIP;4.7uF,10%,6.3V,X5R,TP,1608,-5	11	SNA
....6	AD480	2203-006399	C-CER,CHIP;1uF,10%,6.3V,X5R,TP,1005,-55t	30	SA
....6	AD480	2203-006427	C-CER,CHIP;4.7uF,10%,16V,X5R,TP,2012,T1.	10	SA
....6	AD480	2203-006460	C-CER,CHIP;2.2uF,10%,16V,X5R,TP,1608,-55	10	SA
....6	AD480	2203-006838	C-CER,CHIP;2.2uF,10%,6.3V,X5R,TP,1005,T0	10	SA
....6	AD480	2203-006890	C-CER,CHIP;10uF,20%,6.3V,X5R,TP,1608,-55	3	SA
....6	AD480	2203-007230	C-CER,CHIP;47uF,20%,6.3V,X5R,TP,2012,T1.	11	SNA
....6	AD480	2203-007240	C-CER,CHIP;22uF,20%,6.3V,X5R,TP,1608,T0.	13	SA
....6	AD480	2203-007271	C-CER,CHIP;2.2uF,10%,10V,X5R,TP,1005,T0.	1	SNA
....6	AD480	2203-007306	C-CER,CHIP;10uF,10%,25V,X5R,TP,2012,T1.2	11	SNA
....6	AD480	2203-007544	C-CER,CHIP;100nF,10%,50V,X7R,TP,1005,T0.	1	SA
....6	AD480	2203-008096	C-CER,CHIP;2.2uF,10%,50V,X5R,TP,2012,T1.	10	SA
....6	AD480	2203-008412	C-CER,CHIP;4.7uF,10%,50V,X5R,TP,2012,T1.	18	SNA
....6		2703-003747	INDUCTOR-SMD;22uH,20%,6060,0.135ohm,1300	1	SA
....6		2703-003862	INDUCTOR-SMD;10uH,20%,6060,0.065ohm,1900	4	SA
....6		2703-004226	INDUCTOR-SMD;8.2uH,20%,10.7x10mm,T3.8,0.	1	SA
....6		2804-001595	OSCILLATOR-CLOCK;27MHz,50ppm,10TTL,15pF,	1	SNA
....6		3301-002039	BEAD-SMD;26ohm/100Mhz,1.6X0.8mm,TP,7mohm	1	SA
....6		3601-001374	FUSE-SURFACE MOUNT;32V,5A,FAST-ACTING,PL	1	SA
....6		3708-003073	CONNECTOR-FPC/FFC/PIC;51P,0.5mm,SMD-A,AU	10	SA
....6		3708-003355	CONNECTOR-FPC/FFC/PIC;TP,SMD-A,24P,0.5mm	1	SNA
....6		3711-008454	HEADER-BOARD TO CABLE;BOX,22P,2R,2mm,ANG	1	SA
....6		BN41-03005A	PCB-FPGA;Y22_4K_75_Q85_AM_LED_7A50,FR-4,	1	SNA
....6		BN61-13312B	BRACKET-SCREWLESS PCB;55KS8000,SK5,T0.3,	4	SNA
....6		BN97-19375A	ASSY MICOM;Q700B,Q95B,1107-002566,BN94-1	1	SNA
.....7		1107-002566	IC-NOR FLASH;W25Q32JVSSIQ,32Mbit,16384x2	1	SA
...4		BN95-08617A	ASSY LED BAR-Q85B 75 SET ASSY;Q85B/Q75B	1	SNA
...4		BN96-54856A	FFC;QN90B 75,Fold,L520,51P,LED- Driver #	1	SA
...4		BN96-54857A	FFC;QN90B 75,Fold,L320,51P,LED- Driver #	1	SA
...4		BN96-54858A	FFC;QN90B 75,Fold,L480,51P,LED- Driver #	1	SA
...4		BN96-54859A	FFC;QN90B 75,Fold,L770,51P,LED- Driver #	1	SA
...4		BN96-54860A	FFC;QN90B 75,Fold,L860,51P,LED- Driver #	1	SA

Exploded Views and Parts List

Level	Loc.	Part Code	Description & Specification	Qty.	SA/SNA
...4		BN96-54861A	FFC;QN90B 75,Fold,L570,51P,LED- Driver #	1	SA
...4		BN96-54862A	FFC;QN90B 75,Fold,L630,51P,LED- Driver #	1	SA
...4		BN96-54863A	FFC;QN90B 75,Fold,L530,51P,LED- Driver #	1	SA
...4		BN96-54864A	FFC;QN90B 75,Fold,L1200,51P,LED- Driver	1	SA
...4		BN96-54866A	FFC;QN90B 75,Fold,L810,51P,LED- Driver #	1	SA